

Please read and save these instructions. Read through this owner's manual carefully before using product. Protect yourself and others by observing all safety information, warnings, and cautions. Failure to comply with instructions could result in personal injury and/or damage to product or property. Please retain instructions for future reference.

Note: This product can use both steel & aluminium rivet nuts but it is recommended for use with aluminium.

RIVET NUT GUN KIT

The Heavy Duty Rivet Nut Tool easily installs M3, M4, M5, M6, M8, M10 threaded rivet nuts into materials too thin for tapping to allow use of threaded fasteners such as bolts or machine screws.

Prepare tool for use:

1. Select the correct thread size Mandrel/Nose Piece Set that is appropriate for your application.
2. With tool handles in the open position, thread the mandrel into the tool. (Note that threads on tool end of mandrel are reverse threads).
3. Place nose piece over mandrel and thread into tool. (Note that threads on nose piece are reverse threads).

*** IMPORTANT:** When applying rivet nuts to softer materials it may be necessary to use the Limit Stop to prevent over-compression of the Rivet Nut which could distort or weaken the work piece and damage the mandrel.

NOTE: Adjust the Nose Piece in or out of the head of the tool until desired compression is attained, then lock in position by screwing the Limit Stop firmly against head.

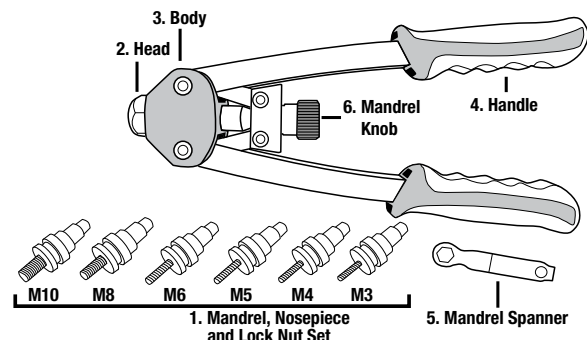

Install Rivet Nut:

1. Thread a Rivet Nut onto the end of the mandrel which protrudes through the nose piece.
2. Push Rivet Nut fully down into correctly sized pre-drilled hole on work piece (Figure 1).
3. Bring handles together firmly to compress back side of Rivet Nut. This will force the Rivet Nut to barrel outward and clench the work piece tightly (Figure 2).*
4. Unscrew the mandrel from the installed Rivet Nut by turning the mandrel knob counter-clockwise (Figure 3).

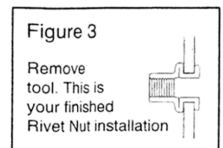
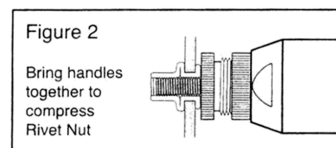
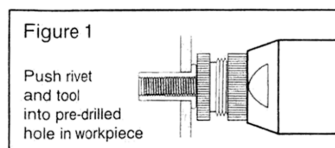
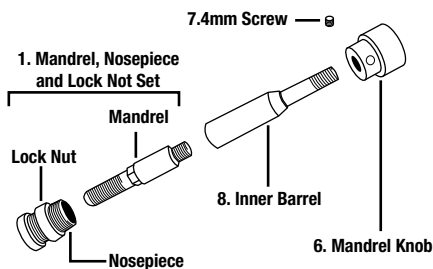

Kit Contents:

Qty	Size	Description	Part #
1		Rivet Nut Gun	K4900
1		MANDREL M3	K4900-1
1		MANDREL M4	K4900-2
1		MANDREL M5	K4900-3
1		MANDREL M6	K4900-4
1		MANDREL M8	K4900-5
1		MANDREL M10	K4900-6

Qty	Size	Description	Part #
10		M3 RIVET NUT	
10		M4 RIVET NUT	
10		M5 RIVET NUT	
10		M6 RIVET NUT	
10		M8 RIVET NUT	
10		M10 RIVET NUT	
1		MANDREL SPANNER	



Scan for instructional video

Spare Parts and accessories:

Qty	Size	Description	Part #
1		MANDREL SET M3	K4900-1
1		MANDREL SET M4	K4900-2
1		MANDREL SET M5	K4900-3
1		MANDREL SET M6	K4900-4
1		MANDREL SET M8	K4900-5
1		MANDREL SET M10	K4900-6
1		SPANNER	K4900-7

Aluminium Rivets:

Qty	Size	Description	Part #
20		M3 NUT ALUM RIVET	K4903
20		M4 NUT ALUM RIVET	K4904
20		M5 NUT ALUM RIVET	K4905
20		M6 NUT ALUM RIVET	K4906
10		M8 NUT ALUM RIVET	K4908
10		M10 NUT ALUM RIVET	K4910

Zinc Steel Rivets:

Qty	Size	Description	Part #
20		M3 NUT STEEL RIVET	K4953
20		M4 NUT STEEL RIVET	K4954
20		M5 NUT STEEL RIVET	K4955
20		M6 NUT STEEL RIVET	K4956
10		M8 NUT STEEL RIVET	K4958
10		M10 NUT STEEL RIVET	K4951