



ENGINE SUPPORT BAR

K12106

Distributed by Kincrome Group www.kincrome.com.au

Owner’s Assembly and Operating Manual

- SPECIFICATIONS2
- IMPORTANT SAFETY INFORMATION3
- UNPACKING AND ASSEMBLING SUPPORT BAR.....3
 - Unpacking Carton3
- OPERATING SUPPORT BAR4
 - Preparing Work Area4
 - Using the Support Bar.....4
 - Working on Engine5
- MAINTENANCE AND STORAGE5
 - Lubricating.....5
 - Cleaning5

SPECIFICATIONS

Working Load Limit	500 KG
Adjustable Length	730-1480 mm
Adjustable Height	0-205 mm
Total Weight:	19 KG
Part Number	K12106

IMPORTANT SAFETY INFORMATION

The use of an engine support bar has inherent dangers to avoid risk of personal injury or property damage make sure you are fully aware of the operating instructions for this product and any recommendations in the vehicle owners manual prior to using this tool. Do not exceed maximum lifting capacity of this engine support bar. This engine support bar is intended for automotive use only. Be aware that large or heavy engines may exceed the stated capacity check vehicle owners manual or contact the engine manufacturer. Do not use for any other purpose except the supporting of an engine in the engine bay.

Warning dynamic (load which swings, slips from center or moves quickly) loads can exert a force much greater than their physical mass (weight) resulting in failure of the support bar and/or loss of the load leading to property damage, personnel injury, even death.

This is a support bar is not a lifting device? It is meant only to keep an installed engine in place while repairs are undertaken.

UNPACKING AND ASSEMBLING SUPPORT BAR

Unpacking Carton

Place carton in a clear, open area such as garage floor. Remove components and lay them out neatly on selected work surface. Make sure all nuts, bolts, washers, and pins, are properly identified and placed safely until needed

Step 1, Lay base #5 out on a firm surface. Make sure there is sufficient room to assemble the support bar and to move it once assembled.

Step 2, holding foot #8 attach rubber feet to both sides. Place pivot #6 over foot and secure with M12x25 bolt #7. Pass threaded bar of #6 through support bar and secure with washer #4 and #12 lock nut

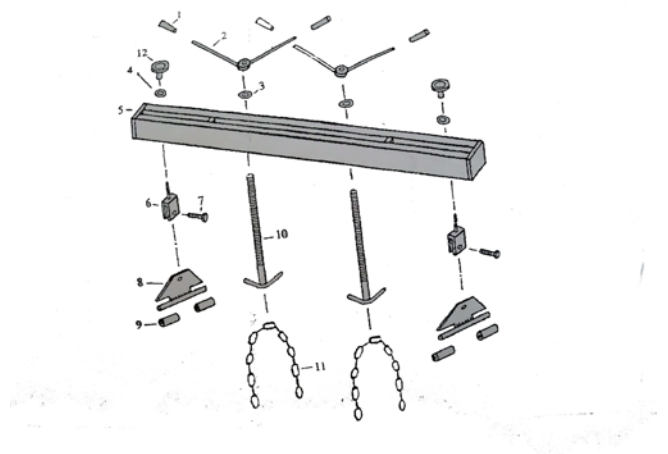

Step 3, repeat step two for other side

Step 4, Pass adjustable hook #10 through base and secure with washer #3 and Grip handle #2. Push handle sleeves #1 onto ends of grip handle #2

Step 5, repeat step 4 for second adjustable hook

- Supporting an engine using an engine support bar can be dangerous. This engine support bar is designed and intended for use by properly trained and experienced personnel only. If you are not familiar with the proper and safe operation of an engine support bar, do not use until proper training and knowledge have been obtained.

OPERATING SUPPORT BAR

Preparing Work Area

Before using the support bar, it is important to prepare work area properly. Follow this procedure each time the support bar is used to help prevent property damage and or serious injury.

- 1.) Thoroughly inspect support bar for damage or wear before each use. Briefly test operation of unloaded support bar before using to support any load. If bar is damaged or is malfunctioning **DO NOT SUPPORT ANY LOAD** until the problem is corrected.
- 2.) Consult vehicle owner's manual for safety precautions, engine weight, and location of support areas on engine. The working load limit of this engine support bar is between 500 kg. **NEVER EXCEED WORKING LOAD LIMIT OF** support bar.
- 3.) Loads which are allowed to swing or move off center can exert a force greater than the weight of the object lifted. Make sure load is secured and not able to move from the vertical lifting line.
- 4.) Clear children and others from work area before commencing work. Another adult should be nearby for extra safety and assistance but must be clear of vehicle as it is worked on.
- 5.) Clear obstructions from work area. Working in tight or cluttered work areas is dangerous.
- 6.) Be sure vehicle is on solid, level ground such as paved or concrete driveway or garage floor. Uneven or sloped surfaces create hazardous working conditions and dangerously impeded the function of the support bar.
- 7.) With vehicle in proper position, set vehicle's parking brake or emergency brake and put gearshift in park (manual transmissions should be placed in lowest gear). **TURN VEHICLE IGNITION OFF AND TO THE "LOCK" POSITION** making sure steering wheel locks.
- 8.) Chock all wheels of vehicle to prevent vehicle rolling. Using wedge-shaped blocks that tyre cannot roll over, position one chock tight against the tyre in both forward and reverse rolling paths.

Using the Support Bar

Follow all instructions and precautions below.

- 1.) With support bar properly assembled, place the support bar across the engine with the standing brackets flush against channel, do not place on panel, or any other surface which cannot hold the intended weight of the engine.
- 2.) Attach Chains #11 to the Engine and Support bar, making sure the device is securely attached to the engine and is suitably rated to hold the weight.
- 3.) Slowly Twist grip handle #2 evenly on both sides. Rotate grip handles until support bar just begins to support the weight of the engine.
- 4.) Inspect engine securing device making sure it is properly attached to the engine.
- 5.) Undo engine mount or perform other repair. Slight adjust of the grip handle maybe required to maintain engine position after other fasteners are loosened or removed.
- 6.) Never leave an engine suspended by an engine support bar – the product is intended for short term use during repair. As soon as is practicable engine should be repaired and engine support bar removed.

7.) NEVER work under an engine supported by an engine support bar. Never place any part of your body under an engine supported by a Support bar.

Working on Engine

Any engine being supported by an engine support bar creates a potentially hazardous working environment. Never place any part of your body beneath an engine supported by an engine support bar. Work should only be attempted on the removed engine once it is no longer supported by the crane, either securely attached to an engine stand or other suitable supporting device.

MAINTENANCE AND STORAGE

Lubricating

Moving parts on engine support bar should be lubricated occasionally with a light machine oil to maintain efficient operation.

Cleaning

Engine Support Bar should be wiped clean with soft cloth only. Do not use gasoline, kerosene, or other such solvents or any abrasive cleanser.

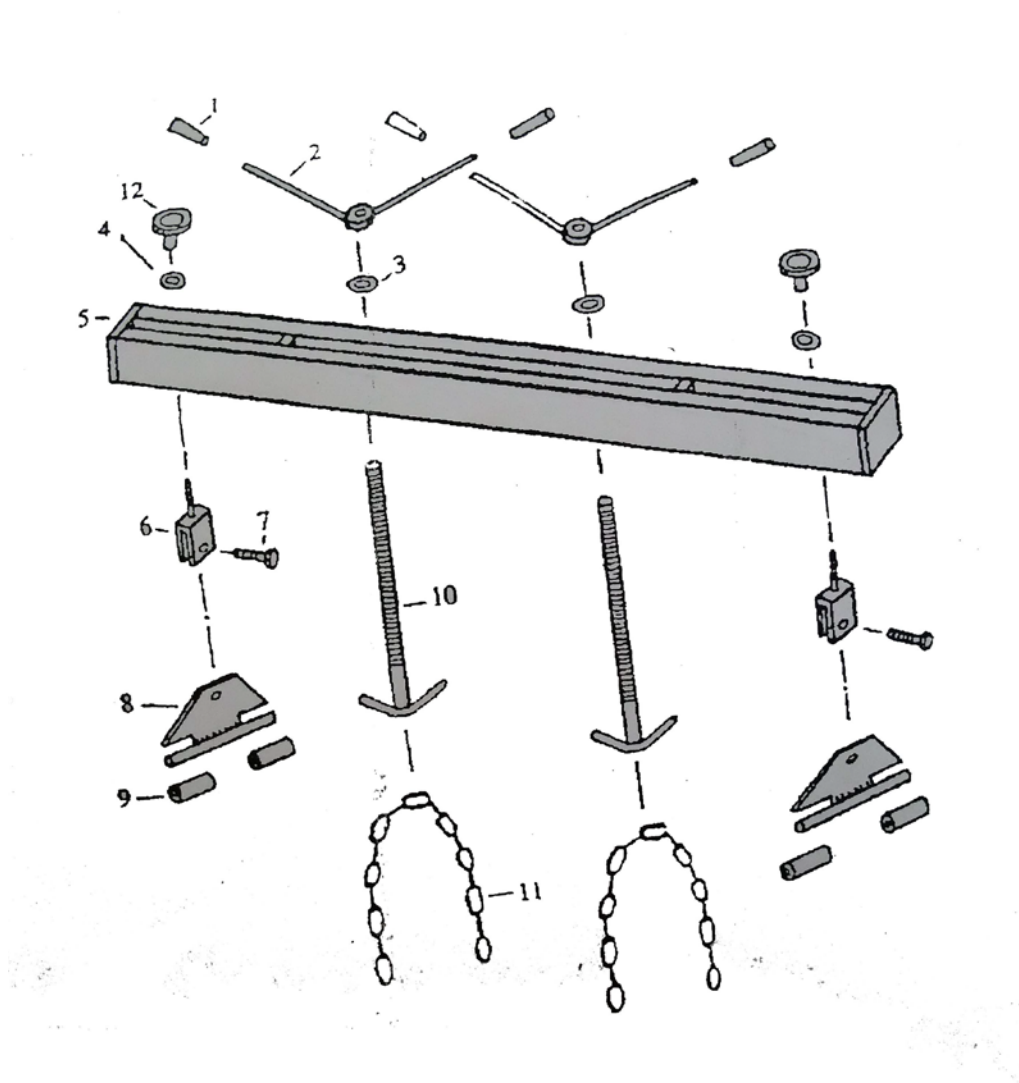

Ref#	Description	Qty	Ref#	Description	Qty
1	Handle Sleeve	4	7	Bolt M12x25	2
2	Grip Handle	2	8	Standing Bracket	2
3	Washer	2	9	Rubber Block	4
4	Washer	2	10	Adjustable Screw	2
5	Beam	1	11	Chain	2
6	Standing Block and Bolt	2	12	Lock Nut	2

Warranty given by Kincrome Australia Pty Ltd of 3 Lakeview Drive, Caribbean Park, Scoresby, Victoria (Tel 1300 657 528). If this product has materials or workmanship defects (other than defects caused by abnormal or non warranted use) you can , at your cost, send the product to place of purchase, an authorized Kincrome service agent or one of Kincrome's addresses for repair or replacement. Your rights under this warranty are in addition to any other rights you have under the Australian Consumer Law or other applicable laws. Our goods come with guarantees that cannot be excluded under the Australian Consumer Law. You are entitled to a replacement or refund for a major failure and compensation for any other reasonably foreseeable loss or damage. You are also entitled to have the goods repaired or replaced if the goods fail to be of acceptable quality and the failure does not amount to a major failure.

For further details please visit www.kincrome.com.au or call us

Distributed by Kincrome Tools and Equipment

www.kincrome.com.au

3 Lakeview Drive Scoresby Victoria

Phone: 1300 657 528

