

KINCROME[®]

PROFESSIONAL QUALITY TOOLS

METAL BENDER 730MM

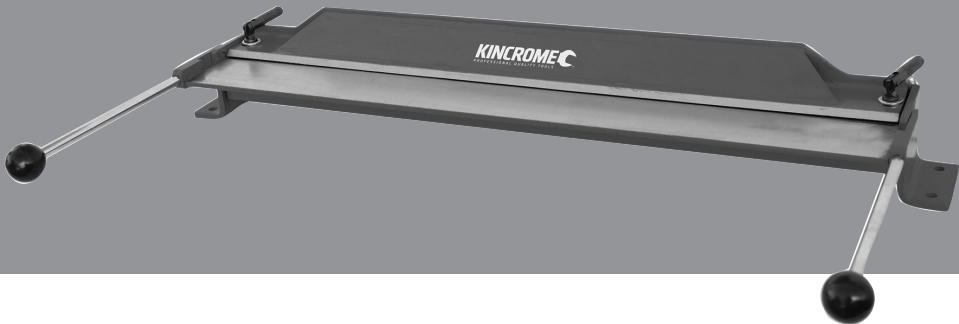
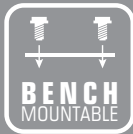

KP15201
ED1 JAN 2018



NOTICE! If you are new to Metal Bending, we **STRONGLY RECOMMEND** that you seek training prior to using this Metal Bender. Kincrome will not be liable for accidents caused by lack of knowledge or training.

Table of Contents

Know Your Product	1
Safety Instructions.....	2-3
Assembly Instructions.....	3
Operation Instructions	3
Trouble Shooting.....	4
Spare Parts & Warranty.....	5

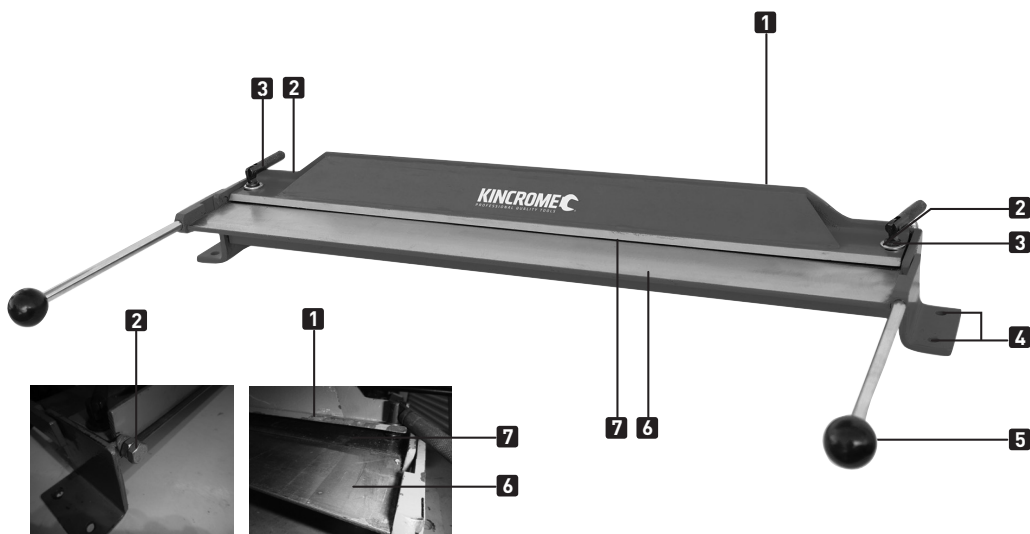

Know your product

- | | |
|-------------------------------------|-----------------|
| 1. Clamp Plate | 6. Folding Leaf |
| 2. Clamp Plate Adjustment Bolt (x2) | 7. Bed |
| 3. Clamp Plate Locking Handle (x2) | |
| 4. Mounting Holes | |
| 5. Folding Leaf Handle (x2) | |

Model No:..... KP15201

Maximum Bending Capacity:

Mild Steel:	1.2mm
Aluminum.....	1.5mm
Stainless Steel:	1.0mm

Maximum Width:..... 730mm

Bend Angle: 0-120°

Net Weight:..... 18kg

GENERAL SAFETY WARNINGS



Save all warnings and instructions for future reference.

WARNING! Read all safety warnings and all instructions. Failure to follow the warnings and instructions may result in serious injury.

WARNING: The warnings, cautions, and instructions discussed in this instruction manual cannot cover all possible conditions and situations that may occur. It must be understood by the operator that common sense and caution are factors which cannot be built into this product, but must be supplied by the operator.

1) WORK AREA

- a) **Keep work area clean and well lit.** Cluttered and/or dark areas invite accidents.
- b) **Keep children and bystanders away while operating a Metal Bender.** Distractions can cause you to lose concentration.
- c) **This Metal Bender is not intended for use by persons (including children) with reduced physical, sensory or mental capabilities, or lack of experience and knowledge, unless they have been given supervision or instruction concerning use of the Metal Bender by a person responsible for their safety.**
- d) **Children should be supervised to ensure that they do not play with the Metal Bender. This Metal Bender is not a toy.**

2) PERSONAL SAFETY

WARNING! Always wear Australian compliant personal protective equipment.

- a) **Stay alert, watch what you are doing and use common sense when operating a Metal Bender.** Do not use a Metal Bender while you are tired or under the influence of drugs, alcohol or medication. A moment of inattention while operating Metal Benders may result in serious personal injury.
- b) **Use personal protective equipment.** Always wear eye protection. Protective equipment such as gloves, dust mask, non-skid safety shoes with steel caps, hard hat, full face shield, and/or hearing protection used for appropriate conditions will reduce personal injuries.
- c) **Do not overreach. Keep proper footing and balance at all times.** This enables better control of the Metal Bender at all times.
- d) **Dress properly. Do not wear loose clothing or jewellery. Keep your hair, clothing and gloves away from moving parts.** Loose clothes, jewellery or long hair can be caught in moving parts.

3) ADDITIONAL SAFETY WARNINGS FOR FOLDERS

WARNING! DO NOT let comfort or familiarity with product (gained from repeated use) replace strict adherence to the Metal Bender safety rules. If you use this Metal Bender unsafely or incorrectly, serious personal injury may occur.

- a) **Do not force the Metal Bender. Use the correct Metal Bender for the application.** The correct Metal Bender will do the job better and safer at the rate for which the Metal Bender is designed.
- b) **Do not modify or alter this Metal Bender or use it for an unintended purpose.**
- c) **Only use this device when fixed on a surface that is stable, level, dry and not slippery, and capable of sustaining the load.**
- d) **Do not use the Metal Bender if any parts are damage broken or misplaced.** Repair or replace the parts.
- e) **The workpiece may be sharp. After bending workpieces, use caution.** Be aware of sharp edges or sharp shreds of metal that may be created. Use heavy gloves when handling the workpiece.
- f) **Remove adjusting keys and wrenches before using Metal Bender.** The Metal Bender may eject an attached wrench or a key and cause an injury to you or a bystander.

4) SERVICE

- a) **Have your Metal Bender serviced by a qualified repair person using only identical replacement parts.** This will ensure that the correct operation of the Metal Bender is maintained.

5) DESCRIPTION OF SYMBOL

The following symbols are shown on the tool:



Wear Safety Gloves



Wear Safety Boots



Read the instruction manual before use



Warning



Beware of Sharp edges



Wear Eye Protection



Wear Ear Protection



Wear Head Protection



Crush Hazard

UNPACKING

After unpacking, check to make sure that all parts shown in "Know Your Product" have been supplied. If any parts are missing or broken, please contact the place of purchase.

ASSEMBLY

Note: For identification of the components mentioned in the following pages, refer to the "Know Your Product" on page 1.

1. The unpainted surface of the Metal Bender is coated with a rust preventing waxy oil and should be removed before you begin operating. Use a solvent cleaner that will not damage painted surfaces.
2. Using the four Mounting Holes (4), and secure the folder to a strong, stable workbench using four strong bolts, nuts and washers (not included) (Fig 1A).
3. Thread each Folding Leaf Handle (5) into the ends of the Folding Leaf (5) (Fig 1B).

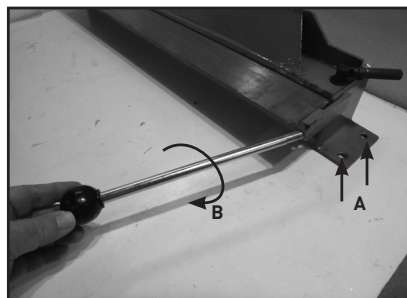

Fig 1

ADJUSTMENTS

WARNING! Never exceed the maximum bending capacity (as specified in the specifications).

1. Set the Clamp Plate (1) at the correct distance back and parallel to the front edge of the Bed (7) by adjusting the Clamp Plate Adjustment Bolt (2) (Fig 2A). A larger distance is required for thicker material.

NOTE: Make a few test bends from the same material BEFORE making a bend in the work piece.

NOTE: When using a 1.5mm thickness material, you will need to adjust the Clamp Plate (2) back to approximately 1.5mm. This will allow the folder to produce an accurate bend and avoid any damage to the tool. If the Clamp Plate (2) is not adjusted correctly to accommodate the thickness of the material, you may not be able to bend the material to desired angle and, if forced, could cause damage to the bender.

2. Ensure the lock nut (Fig 2B) on the Clamp Plate Adjustment Bolt (2) is tight so the the Clamp Plate Adjustment Bolt (2) does NOT move (Fig 2).

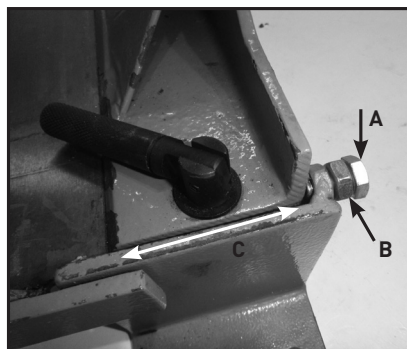

Fig 2

OPERATION

1. Mark a line on the work piece where the fold is to be made (Fig3).
2. With the Folding Leaf (6) horizontal, slide the work piece across the folding leaf and between the Bed (7) and the Clamp Plate (1) (Fig 3). Loosen the two Clamp Plate Locking Handles (3) further if required (Fig 5).
3. Align the fold line on your work piece with the front edge of the Clamp Plate (2) (Fig 4).
4. Tighten the two Clamp Plate Locking Handles (3) to hold the work piece firmly in position (Fig 5).
5. Using the two Folding Leaf Handles (5) lift the Folding Leaf (6) until the required angle of bend is achieved.

Note: Usually the work piece will need to be bent slightly further over, as the natural "spring" of the work piece material will slightly reduce the angle of the bend, check angle after bending.

WARNING! When bending material, keep hands clear of the Bed (7), Clamp Plate (1) and Folding Leaf (6) to avoid injury.

Cleaning and Maintenance

1. Keep all areas of the tool clean, particularly those surfaces that contact sheetmetal workpieces. Dirt and metal chips can cause marking of the workpiece.
2. Use a mild solvent cleaner that will not damage painted surfaces. Wipe the unpainted parts of the Metal Bender with a light coat of camellia oil to prevent rust.
3. Store in a clean & dry environment when not in use.



Fig 3

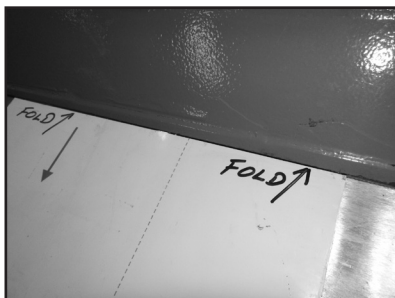

Fig 4

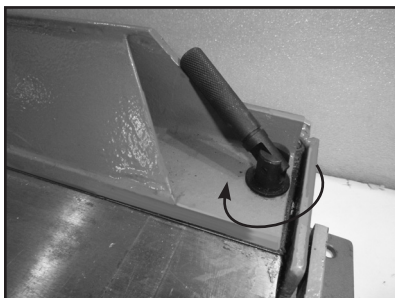

Fig 5

7) TROUBLESHOOTING

PROBLEM	CAUSES	SOLUTIONS
Metal Bender won't perform bend	Material thickness exceeded	Cease operation of tool or use larger metal bender
	Clamp Plate (2) NOT adjusted correctly	Adjust Clamp Plate (2) to allow for correct Material Thickness
The bend is NOT a true 90°	Clamp Plate (2) NOT adjusted correctly	Adjust Clamp Plate (2) to allow for correct Material Thickness
	Material too Thick	Cease operation of tool or use larger metal bender
	Did not fold slightly past 90° angle to allow for spring back	Rebend past 90° to allow for spring back

IMPORTANT!

If the metal bender still fails to operate correctly after you have carried out the troubleshooting operations, or in the event of anomalies other than those described above, contact Kincrome Customer Service on 1300 657 528 for assistance.

SPARE PARTS

For a full list of available spare parts for this item visit the Kincrome website kincrome.com.au or alternatively contact Kincrome Customer Service.



Warranty given by Kincrome Australia Pty Ltd of 3 Lakeview Drive, Caribbean Park, Scoresby, Victoria (Tel 1300 657 528). The applicable warranty period (12 months) commences on the date that the product is purchased. If this product has materials or workmanship defects (other than defects caused by abnormal or non warranted use) you can, at your cost, send the product to place of purchase, an authorised Kincrome service agent or one of Kincromes addresses for repair or replacement. Your rights under this warranty are in addition to any other rights you have under the Australian Consumer Law or other applicable laws. Our goods come with guarantees that cannot be excluded under the Australian Consumer Law. You are entitled to a replacement or refund for a major failure and compensation for any other reasonably foreseeable loss or damage. You are also entitled to have the goods repaired or replaced if the goods fail to be of acceptable quality and the failure does not amount to a major failure. For further details please visit www.kincrome.com.au or call us. Due to minor changes in design or manufacture, the product you purchase may sometimes differ from the one shown on the packaging.

Australian Office Contact Details



Phone: 1300 657 528



Fax: 1300 556 005



Email: enquiries@kincrome.com.au



Website: www.kincrome.com.au

UK Office Contact Details



Mail: Kincrome UK Ltd PO Box 646
Eastleigh SO50 0NA



Email: enquiries@kincrome.co.uk



Website: www.kincrome.co.uk

PARTS LIST

No.	Description	Qty
1	Bed	1
2	Washer 16mm	2
3	Clamp Plate Locking Handle	2
4	Clamp Plate	1
5	Clamp Plate Adjustment Bolt	2
6	Folding Leaf Handle	2
7	Clamp Plate Lock Nut	2
8	Spring	2
9	Folding Leaf	1

EXPLODED DIAGRAM

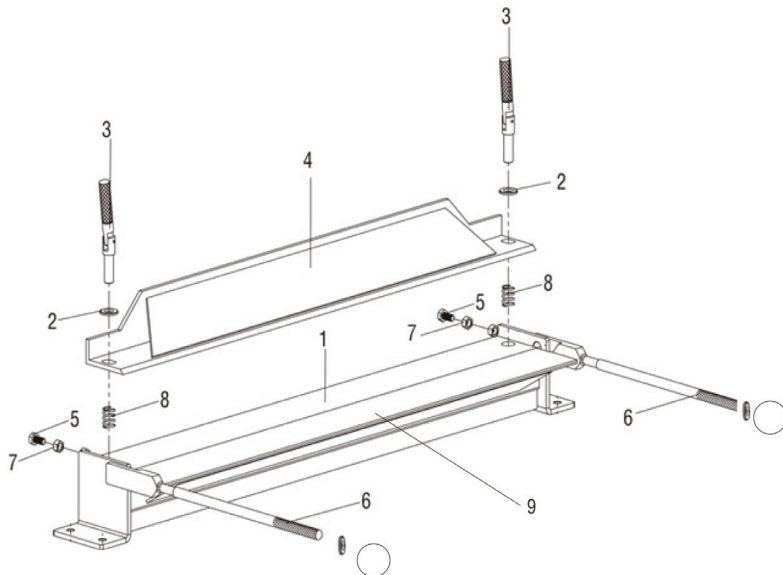



www.kincrome.com.au