

Mobile Work Table

Part No K7074

Assembly Instructions

- Using four 14mm bolts, washers and nuts, install one castor in each square hole on the bottom edge of both the right and left support (7 & 11). Be sure the square bolster on the post of each castor inserts fully into the square hole in the support before tightening.
- Using four 14mm bolts and washers, attach the bolt plate on the right support (7) to the bracket on the tube support (10), ensuring that the castors are facing down. Be sure bolts are securely tightened before proceeding.
- Slide left support tube (11) into the tube support (10) and secure with 17mm bolt and curved washer (12). The curved washer should lay flat against the tubing.
- Laying the top tray (1) upside down on the floor, attach the mounting bracket on silver adjusting tube (5) to the bracket on the bottom of the tray, being sure the groove in the adjusting tube faces AWAY from the centre of the top tray.
- Now, slide the silver adjusting tube with top tray attached into the tube support (10) and secure at the desired height with the T-bolt (6).
- Attach four rubber protector bumpers (2) by pushing the black plastic pins provided into the holes in the corners of the top tray. The pins are inserted from OUTSIDE the tray toward the inside, being sure the rubber bumpers overlap the top edge of the tray.
- Install the four small rectangular plastic inserts (3) into the reinforcement bars under top tray. Then install the four large rectangular plastic inserts (8) into the four holes on the left and right supports (7 & 11).

You are now ready to use your new Mobile Work Table.

Specifications

Overall Tray Dimensions 740(L) x 510(W) x 30mm(D)
Main Tray Area 740(L) x 435(W) x 30mm(D)
3 Compartments 250(L) x 75(W) x 30mm(D)

Tray Gauge 1.5mm
Main Upright Gauge 3.0mm
Lowered Height 850mm
Raised Height 1250mm
Overall Length 740mm
Overall Width 510mm
Weight 16kg

Load Capacity 100kgs (at lowered height)

Note: For every 50mm the tray is raised the load capacity reduces by 5kg

Parts List

Part No	Description	Qty
1.	Top Tray	1
2.	Rubber Corner Bumper with Pins	4
3.	Small Plastic Insert	4
4.	M8 x 14 Bolt with Washer	8
5.	Adjustable Tube (silver)	1
6.	T-Bolt	1
7.	Right Support	1
8.	Large Plastic Insert	4
9.	2" Castor with Nut	4
10.	Tube Support	1
11.	Left Support	1
12.	M10 x 18mm Bolt with Curved Washer	1
13.	EVA Mats	4
14.	Bolts	9

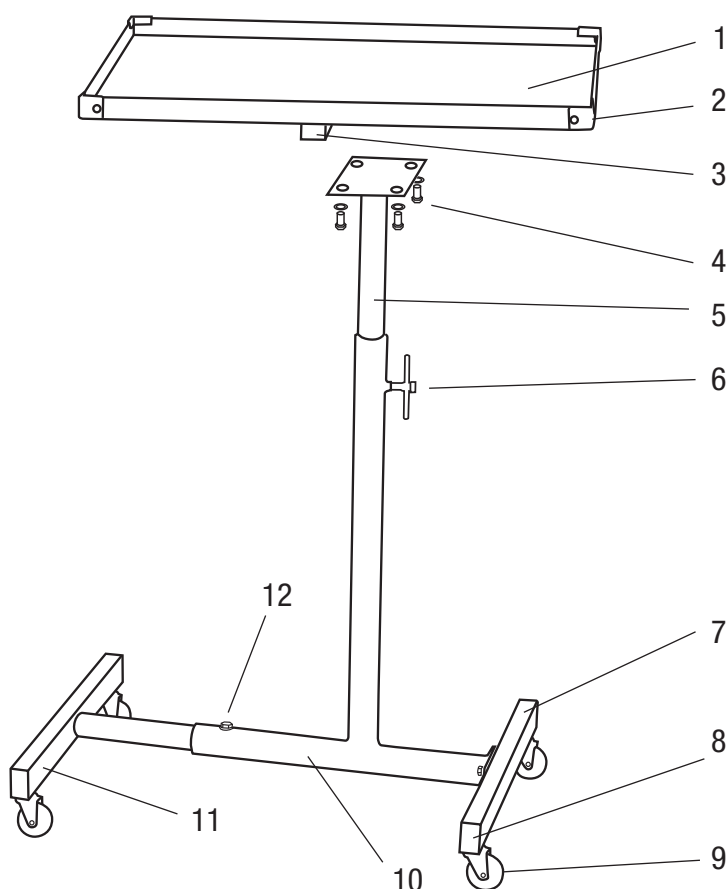

CAUTION
DO NOT EXCEED THE LOAD CAPACITY
OF THIS UNIT