

KINCROME 
PROFESSIONAL QUALITY TOOLS

DIGITAL CLICK TORQUE WRENCH

**48 TOOTH
RATCHET
HEAD
DESIGN**

**PROTECTIVE
BLOW
MOULD
CASE**

**ACCURACY
+/- 2%**

**EASY READ
DIGITAL
DISPLAY
WITH
TRACE**



K8183 & K8184
ED1 SEPTEMBER 2016

Table Of Contents

Know Your Product	2
General Safety Instructions	3
How To Use Your Digital Torque Wrench	3-4
Care & Maintenance	4
Installing/Replacing Batteries	5
Warranty	5

Know Your Product

1. 1/2" Square Drive
2. Release Button
3. Reverse Switch
4. Digital Display
5. Adjustment Knob
6. Multi Function Button
7. Battery Cover

Adjustment Knob Positions

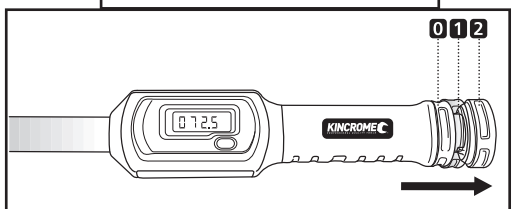

SPECIFICATIONS

	K8183	K8184
Drive Size:	1/2" Square Drive	1/2" Square Drive
Torque Range:	20-200Nm	30-340Nm
Accuracy:	+ / - 2% of Setting	+ / - 2% of Setting
Tool Length:	580mm	650mm
Weight:	1.5kg	1.62kg

GENERAL SAFETY WARNINGS

1. Please study these instructions carefully before attempting to operate this wrench.
2. Never apply more torque than the maximum scale reading.
3. This torque wrench is designed for manual tightening of thread fasteners only.
DO NOT USE IT AS A NUT-BREAKER OR FOR ANY OTHER PURPOSE.
4. Over torqued or defective fasteners and sockets may suddenly break. **TO PREVENT INJURY, KEEP PROPER FOOTING AND BALANCE AT ALL TIMES. DO NOT USE THE WRENCH IN PLACES FROM WHICH YOU MAY FALL OR SLIP, OR AROUND ROTATING MACHINERY.**
5. This torque wrench will not prevent you from applying more torque than set - this is not a torque limiting tool. Learn how different amounts of torque 'feel' so you will reduce the possibility of damage and/or injury due to accidental over torquing.
6. **APPLY FORCE TO THE GRIP ONLY. DO NOT USE AS 'CHEATER BARS'.**
(A piece of pipe placed over the hand grip/ball).
7. All torque wrenches should be calibrated at least once a year or every 1,000 cycles, whichever comes first.
8. This torque wrench operates in both directions, to tighten left and right threads only!
9. Lifetime Warranty does not cover calibration.
10. Be sure all components, including all adaptors, extensions drivers and sockets are rated to match or exceed the torque being applied.
11. Always pull, do not push on the wrench handle and adjust your stance to prevent a possible fall should something give

HOW TO USE YOUR DIGITAL TORQUE WRENCH

WARNING!



1. Your Torque Wrench is a precision instrument and should be treated as such.
2. Always store your Torque Wrench in the protective blow mould case.
3. If your Kincrome Torque Wrench is dropped, knocked, even in the protective blow mould case, or any part replaced, the wrench must be immediately re-calibrated prior to next use.
4. To avoid damaging the wrench: Never use the wrench with the power off.

1

Press the Multi Function Button [6] to turn on the screen, and choose unit of measure.

- Multi Function Button :
- Press for 1 Sec. : turn on the screen
 - Press for 3 Sec. : the units of measure will start to flash, every press the units will change as following, Kg-f-cm -> N-m -> Ft-lb
 - The screen will go into hibernation automatically after 1 min to save power

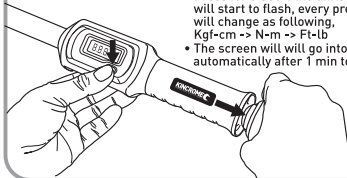
**2**

Pull out the Adjusting Knob [5] all the way out to **2** position, adjust the torque by rotating the knob.

Adjusting Knob: • C,W direction to increase the torque;
C,C,W direction to decrease the torque,

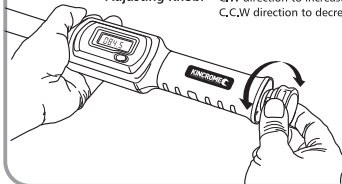

HOW TO USE YOUR TORQUE WRENCH (Continued)**3**

Fine scale: 0.5 unit

When you rotate the Adjusting Knob [5] follow its finescale to expected torque and find it's not at the normal direction to be pushed back.

Please follow below steps:

(A) Push the Adjusting Knob [5] from **2** Position to **1** Position, now the torque is fixed.

(B) Then rotate the Adjusting Knob [5] to be conform the handle.

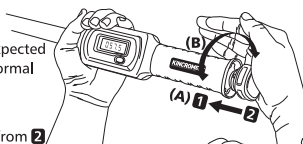

(C) Push the Adjusting Knob [5] back from **1** to **0** position.

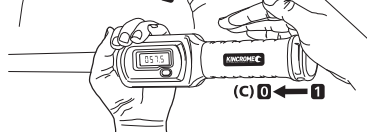
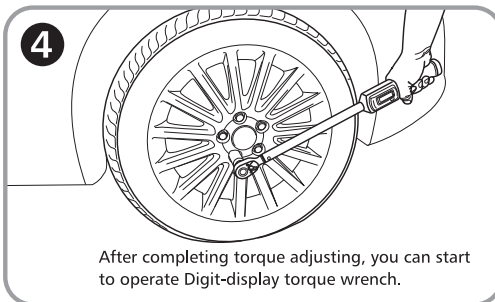
**4**

After completing torque adjusting, you can start to operate Digit-display torque wrench.

SPARE PARTS

- **K8183-1** Ratchet Repair Kit
- **K8184-1** Ratchet Repair Kit

- **K8183-2** Battery Cover

Note: The K8183 and K8184 share the same spare part numbers for identical spare parts.

CARE AND MAINTENANCE

It is normal for torque wrenches to go out of calibration with time and regular use. Whatever type of torque wrench you are using, regular calibration will ensure that your tools remain as accurate and effective as possible.

Putting in place a regular schedule for verifying and calibrating your torque wrench will mean less room for error.

Kincrome Tools and Equipment recommend you have your torque wrench calibrated by a NATA™ approved calibration facility, every 12 months or 1,000 cycles.

If your Kincrome Torque Wrench is dropped, knocked, even in the protective blow mould case, or any part replaced, the wrench must be immediately re-calibrated prior to next use.

Your new Kincrome Torque Wrench is calibrated at the factory in Taiwan, prior to shipping and a certificate of that calibration is supplied for your individually serialised torque wrench. It is the sole responsibility of the owner/user of this tool to ensure the calibration is correct as the Torque Wrench may have gone out of calibration during transit to retailers.

For peace of mind, you should get your torque wrench checked prior to first use.

Please note, the Kincrome Limited lifetime warranty does not cover the cost of calibration, or the removable square drive of the wrench.

INSTALLING/REPLACING BATTERIES

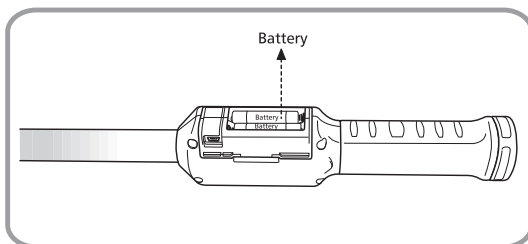

Note: The Kincrome Digital Torque Wrenches do NOT come supplied with batteries. Batteries must be provided by the end user.

1. Remove the Battery Cover (7) which is located opposite to the digital display.
2. Insert 2 X AAA Batteries (not supplied).
3. Reinstall the Battery Cover (7).
4. Your Digital Torque Wrench is now ready to use.

NOTES:

WARRANTY

Warranty given by Kincrome Tools & Equipment Pty Ltd of 3 Lakeview Drive, Caribbean Park, Scoresby, Victoria, Australia (Tel +61 3 9730 7100) If this product has materials or workmanship defects (other than defects caused by abnormal or non warranted use) you can, at your cost, send the product to place of purchase, an authorised Kincrome service agent or one of Kincromes addresses for repair or replacement. Your rights under this warranty are in addition to any other rights you have under the Australian, United Kingdom & Ireland Consumer Law or other applicable laws. Our goods come with guarantees that cannot be excluded under the Australian, United Kingdom & Ireland Consumer Law. You are entitled to a replacement or refund for a major failure and compensation for any other reasonably foreseeable loss or damage. You are also entitled to have the goods repaired or replaced if the goods fail to be of acceptable quality and the failure does not amount to a major failure. For further details please visit www.kincrome.com.au or call us. Due to minor changes in design or manufacture, the product you purchase may sometimes differ from the one shown on the packaging.



www.kincrome.com.au