

10 DRAWER COMBINATION SET CLASSIC

1.

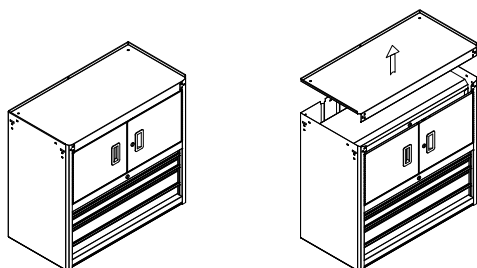

REMOVE UNIT FROM CARTON AND STAND UNIT UPRIGHT. REMOVE CABINET TOP BY LIFTING STRAIGHT UPWARD AND SET ASIDE.

Using a 10mm Spanner or Adjustable wrench, remove the 6pcs bolts/nuts from the cabinet top. Save the bolts/nuts to reinstall later. The Spanner and Adjustable wrench is not included.

2. REMOVE BOTH DRAWERS BELOW THE POWER TOOL STORAGE AREA

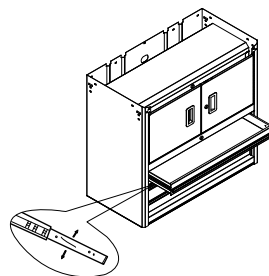

Open and fully extend the top drawer. And then pull the drawer completely out while holding the side release levers, as shown

To release ball bearing slides either push plastic release levers(left and right sides) down and up at the same time. Ensure each is in the opposite direction(up/down or down/up).

3. DISASSEMBLE SCREWS

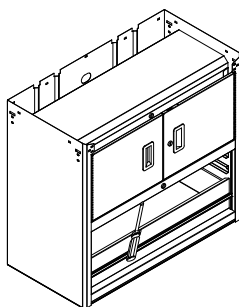

Using a small Phillips screwdriver remove the 4 bolts from under the shelf and set aside. * Do not reinstall drawers at this time. The screwdriver is not included.

4. REMOVE THE CHEST UNIT FROM THE ROLLING CABINET

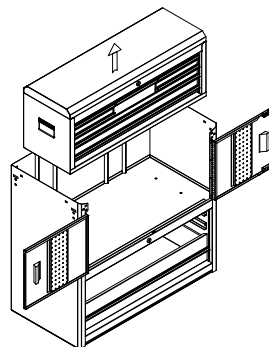

5. REINSTALL CABINET TOP AND MOUNT THE SWIVEL CASTORS

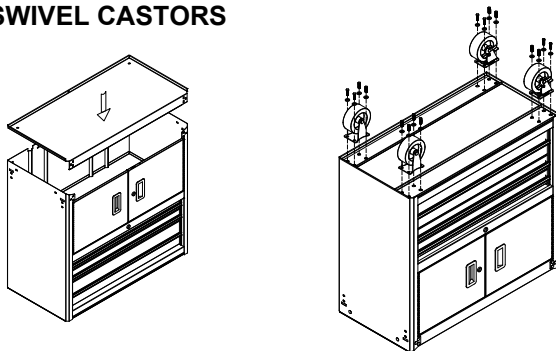

Replace top lid removed in step 1, making sure that the top is flush and all holes in the top and cabinet line up. Fasten screws.

Mount both the swivel castors with toe brake on either left or right side of the rolling cabinet. Tighten with 14mm spanner. The spanner is not included.

6. PRODUCT ASSEMBLY

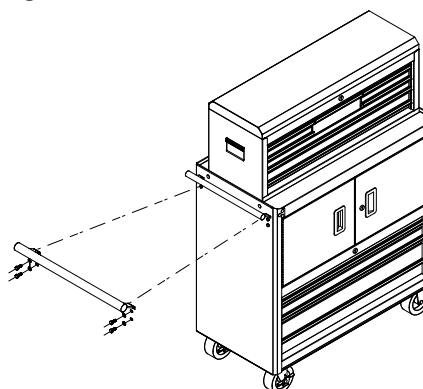

Install the chest on top of the cabinet.

Install the tube side handle on the same side of the rolling cabinet as the swivel castors featuring the toe brake.

Tools Required

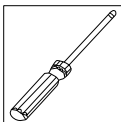
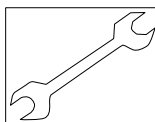

* 10mm spanner or adjustable wrench
* 14mm spanner
* Phillips screwdriver

The Maximum loading capacity is 200 kg (440LB)

K7361