

MOBILE BENCH

Twin Lid
13 Drawer
1600mm **K7371**

OPERATION MANUAL



IMPORTANT:

This operating manual contains important safety information, read carefully & understand all information before operating the mobile bench. Save this manual for future use.



Do not open more than one drawer at a time.



Do not step on drawers.



Do not let children near the Toolbox.



Do not separate Chest from Trolley.



Do not exceed Drawer Load Limit



Not suitable for mounting in Vehicles



Set the brake on the locking castors unless you are moving the Toolbox.



Lock drawers and lid before moving the Toolbox.



PARTS LIST



MEASUREMENTS:

WEIGHT: 198 KG

WIDTH	1600 mm	DEPTH	635 mm	HEIGHT	1000mm
--------------	---------	--------------	--------	---------------	--------

LEFT TOP DRAWER:

WIDTH	833 mm	DEPTH	561 mm	HEIGHT	120 mm
--------------	--------	--------------	--------	---------------	--------

LEFT SMALL DRAWER:

WIDTH	833 mm	DEPTH	561 mm	HEIGHT	78 mm
--------------	--------	--------------	--------	---------------	-------

LEFT LARGE DRAWER:

WIDTH	833 mm	DEPTH	561 mm	HEIGHT	136 mm
--------------	--------	--------------	--------	---------------	--------

RIGHT SMALL DRAWER:

WIDTH	590 mm	DEPTH	561 mm	HEIGHT	78 mm
--------------	--------	--------------	--------	---------------	-------

RIGHT LARGE DRAWER:

WIDTH	590 mm	DEPTH	561 mm	HEIGHT	136 mm
--------------	--------	--------------	--------	---------------	--------

TOP TRAY x2:

WIDTH	719 mm	DEPTH	530 mm	HEIGHT	101 mm
--------------	--------	--------------	--------	---------------	--------

BENCH RATING: 25KG (PER BENCH)

DRAWER RATING: 25KG (PER DRAWER)

CASTOR RATING: 1000KG (6 PIECES)

NOTE: Castors are pre fitted

INCLUDED:



Keys x 2



Trolley Handle x 1

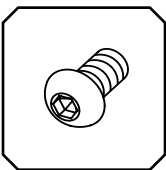

4 x Hex 6mm Bolts for Trolley Handle



12mm x 25 Bolts (24) for Castors



Non-Locking Castors (2)



Locking Castors (4)

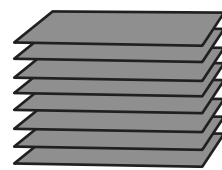

15 x EVA Liners

TOOLS & ASSISTANCE REQUIRED FOR TROLLEY:

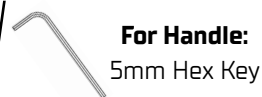
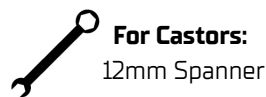

MOBILE BENCH

Twin Lid
13 Drawer
1600mm **K7371**

ASSEMBLY INSTRUCTIONS



CAUTION: Two people are recommended for assembly.

Step 1: Attaching the Cabinet Handle

- Position the cabinet handle (B) over the holes on the cabinet (A).
- Attach with the bolts (AA) and tighten with supplied hex key(BB).



NOTE: The Holes in the cabinet are tapped and do not require nuts

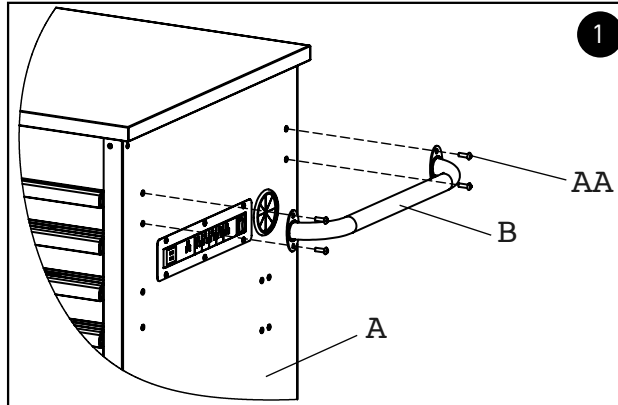

Step 2: Attaching the bottle opener

- Position the bottle opener (D) over the holes of the cabinet (A)
- Attach with the bolts (AA) and tighten with supplied hex key(BB).



CAUTION: Do not over tighten the bolts.

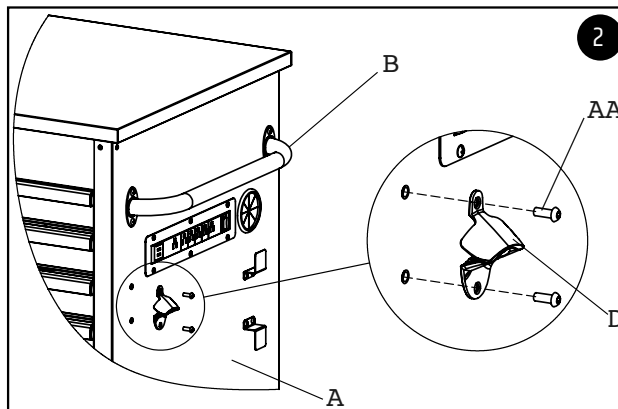

Step 3: Attaching the storage hook

- Position the hook (C) over the holes of the cabinet (A)
- Attach with the bolts (AA) and tighten with supplied hex key(BB).

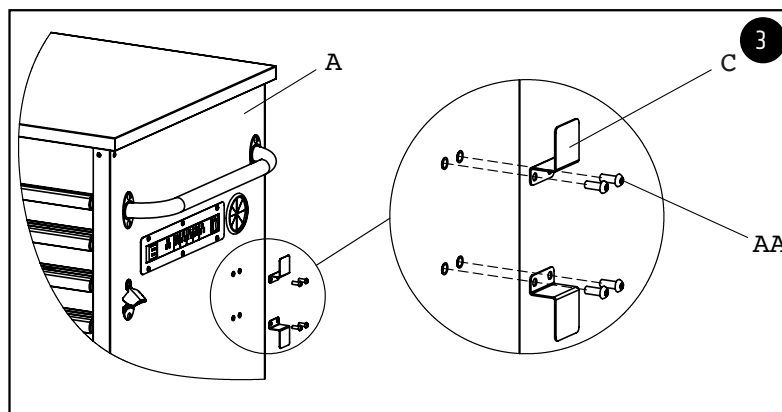

MAINTENANCE

- Periodically tighten all hardware
- Periodically lubricate castors
- Lubricate the slides twice a year
- Lubricate the lock with graphite annually
- Use a damp Microfibre cloth to clean all surfaces
- Use stainless steel cleaner, to clean stainless steel surfaces

MOBILE BENCH

Twin Lid
13 Drawer
1600mm **K7371**

TECHNICAL SPECIFICATIONS

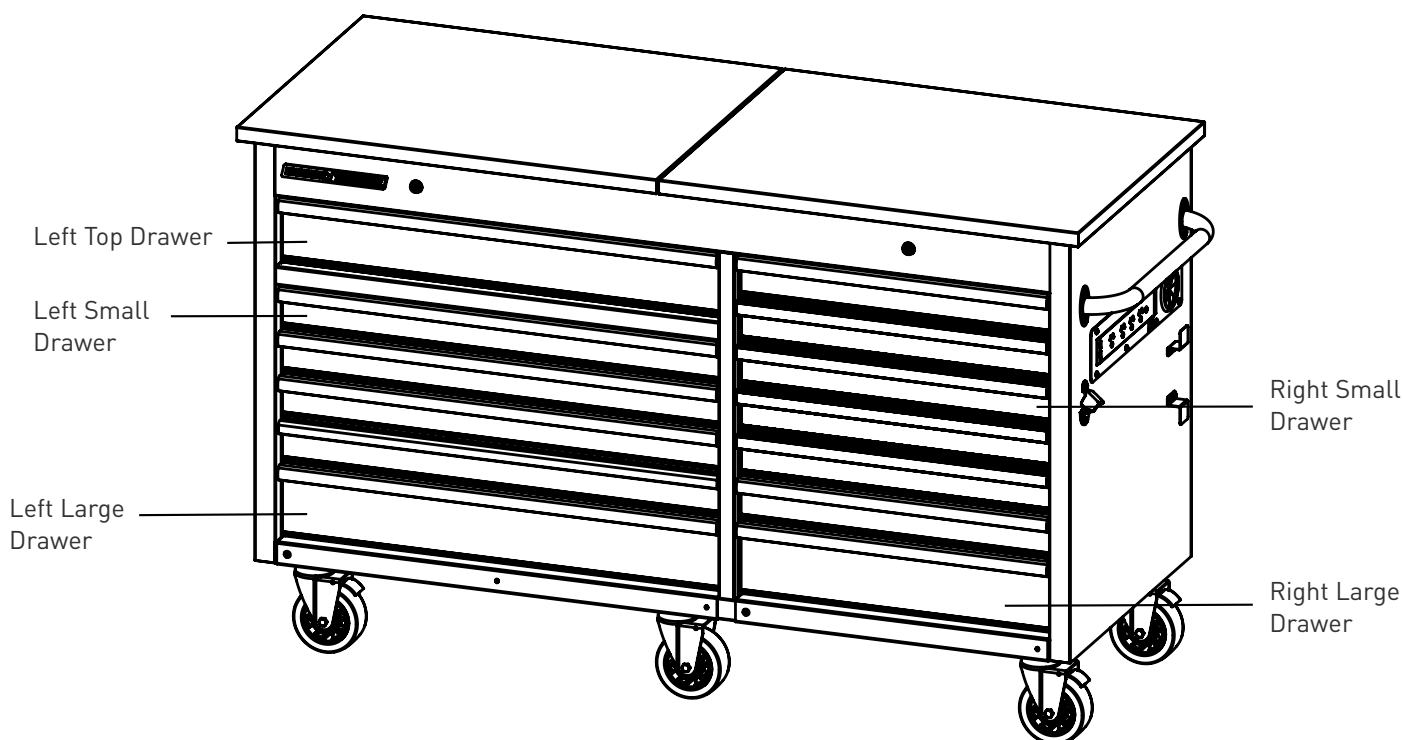

LEFT TOP DRAWER:

WIDTH	833 mm	DEPTH	561 mm	HEIGHT	120 mm
-------	--------	-------	--------	--------	--------

LEFT SMALL DRAWER:

WIDTH	833 mm	DEPTH	561 mm	HEIGHT	78 mm
-------	--------	-------	--------	--------	-------

LEFT LARGE DRAWER:

WIDTH	833 mm	DEPTH	561 mm	HEIGHT	136 mm
-------	--------	-------	--------	--------	--------

RIGHT SMALL DRAWER:

WIDTH	590 mm	DEPTH	561 mm	HEIGHT	78 mm
-------	--------	-------	--------	--------	-------

RIGHT LARGE DRAWER:

WIDTH	590 mm	DEPTH	561 mm	HEIGHT	136 mm
-------	--------	-------	--------	--------	--------

TOP TRAY X2:

WIDTH	719 mm	DEPTH	530 mm	HEIGHT	101 mm
-------	--------	-------	--------	--------	--------

MOBILE BENCH

Twin Lid
13 Drawer
1600mm **K7371**

PARTS LIST



SPARE PARTS

ITEM	PART NO.	DESCRIPTION	QUANTITY
1	K7371-1	Lock & Key	2
2	K7371-2	Key Only (Specify Number)	2
3	K7371-13	Ball Bearing Slide Pair (Deep)	13
4	K7371-3	Stainless Steel Top	2
5	K7371-4	Trolley Handle + Bolts	1
6	K7371-5	Power Board Cover + Bolts	1
7	K7371-6	Power Board	1

ITEM	PART NO.	DESCRIPTION	QUANTITY
8	K7371-7	Power Lead Hook	2
9	K7371-8	Bottle Opener	1
10	K7371-9	Gas Struts (Pair)	2
11	K7371-10	Castor Pack (6)	1
12	K7371-11	Castor Bolt & Washer Pack	1
13	K7371-12	EVA Liner Pack	15
14	K7366-11	Trade Centre Badge	1
15	K7399	T/Centre Matched Key Pack (10)	1

National Head Office
National Distribution and Showroom
3 Lakeview Dve, Caribbean Business Park
Scoresby Victoria 3179 Australia
ABN 41 007 185 006

Administration
T (03) 9730 7100 F (03) 9730 7199
E enquiries@kincrome.com.au
W kincrome.com.au

Customer Service Centre
T 1300 657 528 F 1300 556 005



A family
owned
Australian
business

Made to Kincrome Tools & Equipment Pty Ltd global specifications and quality standards in China

Australia & Global
www.kincrome.com.au
enquiries@kincrome.com.au