

KINCROME **PT18**

18V Brushless Hammer Drill/Driver

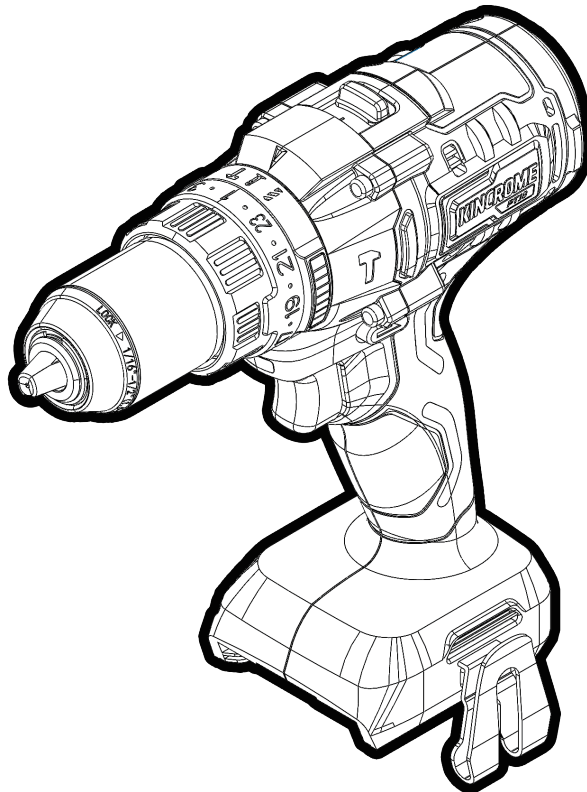

K23010

ED2 December 2023

General Power Tool Safety Warnings

K23010



WARNING Read all safety warnings and all instructions. Failure to follow the warnings and instructions may result in electric shock, fire and/or serious injury. Save all warnings and instructions for future reference. The term "power tool" in the warnings refers to your mains-operated (corded) power tool or battery-operated (cordless) power tool.

1) Work area safety

- a) **Keep work area clean and well lit.**
Cluttered or dark areas invite accidents.
- b) **Do not operate power tools in explosive atmospheres, such as in the presence of flammable liquids, gases or dust.** *Power tools create sparks which may ignite the dust or fumes.*
- c) **Keep children and bystanders away while operating a power tool.** *Distractions can cause you to lose control.*

2) Electrical safety

- a) **Power tool plugs must match the outlet. Never modify the plug in any way. Do not use any adapter plugs with earthed (grounded) power tools.** *Unmodified plugs and matching outlets will reduce risk of electric shock.*
- b) **Avoid body contact with earthed or grounded surfaces, such as pipes, radiators, ranges and refrigerators.** *There is an increased risk of electric shock if your body is earthed or grounded.*
- c) **Do not expose power tools to rain or wet conditions.** *Water entering a power tool will increase the risk of electric shock.*
- d) **Do not abuse the cord. Never use the cord for carrying, pulling or unplugging the power tool. Keep cord away from heat, oil, sharp edges or moving parts.** *Damaged or entangled cords increase the risk of electric shock.*
- e) **When operating a power tool outdoors, use an extension cord suitable for outdoor use.** *Use of a cord suitable for outdoor use reduces the risk of electric shock.*
- f) **If operating a power tool in a damp location is unavoidable, use a residual current device (RCD) protected supply.** *Use of an RCD reduces the risk of electric shock.*

3) Personal safety

- a) **Stay alert, watch what you are doing and use common sense when operating a power tool. Do not use a power tool while you are tired or under the influence of drugs, alcohol or medication.** *A moment of inattention while operating power tools may result in serious personal injury.*
- b) **Use personal protective equipment. Always wear eye protection.** *Protective equipment such as dust mask, non-skid safety shoes, hard hat, or hearing protection used for appropriate conditions will reduce personal injuries.*
- c) **Prevent unintentional starting. Ensure the switch is in the off-position before connecting to power source and/or battery pack, picking up or carrying the tool.** *Carrying power tools with your finger on the switch or energising power tools that have the switch on invites accidents.*
- d) **Remove any adjusting key or wrench before turning the power tool on.** *A wrench or a key left attached to a rotating part of the power tool may result in personal injury.*
- e) **Do not overreach. Keep proper footing and balance at all times.** *This enables better control of the power tool in unexpected situations.*

- f) **Dress properly. Do not wear loose clothing or jewellery. Keep your hair, clothing and gloves away from moving parts.** *Loose clothes, jewellery or long hair can be caught in moving parts.*
- g) **If devices are provided for the connection of dust extraction and collection facilities, ensure these are connected and properly used.** *Use of dust collection can reduce dust-related hazards.*
- h) **Do not let familiarity gained from frequent use of tools allow you to become complacent and ignore tool safety principles.** *A careless action can cause severe injury within a fraction of a second.*

4) Power tool use and care

- a) **Do not force the power tool. Use the correct power tool for your application.** *The correct power tool will do the job better and safer at the rate for which it was designed.*
- b) **Do not use the power tool if the switch does not turn it on and off.** *Any power tool that cannot be controlled with the switch is dangerous and must be repaired.*
- c) **Disconnect the plug from the power source and/or the battery pack from the power tool before making any adjustments, changing accessories, or storing power tools.** *Such preventive safety measures reduce the risk of starting the power tool accidentally.*
- d) **Store idle power tools out of the reach of children and do not allow persons unfamiliar with the power tool or these instructions to operate the power tool.** *Power tools are dangerous in the hands of untrained users.*
- e) **Maintain power tools. Check for misalignment or binding of moving parts, breakage of parts and any other condition that may affect the power tool's operation. If damaged, have the power tool repaired before use.** *Many accidents are caused by poorly maintained power tools.*
- f) **Keep cutting tools sharp and clean.** *Properly maintained cutting tools with sharp cutting edges are less likely to bind and are easier to control.*
- g) **Use the power tool, accessories and tool bits etc. in accordance with these instructions, taking into account the working conditions and the work to be performed.** *Use of the power tool for operations different from those intended could result in a hazardous situation.*
- h) **Keep handles and grasping surfaces dry, clean and free from oil and grease.** *Slippery handles and grasping surfaces do not allow for safe handling and control of the tool in unexpected situations.*

5) Battery tool use and care

- a) **Recharge only with the charger specified by the manufacturer.** *A charger that is suitable for one type of battery pack may create a risk of fire when used with another battery pack.*
- b) **Use power tools only with specifically designated battery packs.** *Use of any other battery packs may create a risk of injury and fire.*
- c) **When battery pack is not in use, keep it away from other metal objects, like paper clips, coins, keys, nails, screws or other small metal objects, that can make a connection from one terminal to another.** *Shorting the battery terminals together may cause burns or a fire.*

- d) Under abusive conditions, liquid may be ejected from the battery; avoid contact. If contact accidentally occurs, flush with water. If liquid contacts eyes, additionally seek medical help. Liquid ejected from the battery may cause irritation or burns.
- 6) Service
 - a) Have your power tool serviced by a qualified repair person using only identical replacement parts. This will ensure that the safety of the power tool is maintained.

Tool Assembly

K23010

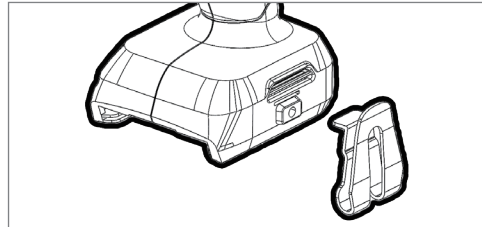

Additional Safety Instructions Drill



Drill safety warnings

1) Safety instructions for all operations

- a) **Wear ear protectors when impact drilling.**
Exposure to noise can cause hearing loss.
NOTE 1 The above warning applies only to **impact drills** and is omitted for **drills**.
 - b) **Use the auxiliary handle(s).** *Loss of control can cause personal injury.*
NOTE 2 The above warning applies only to tools that are provided with auxiliary handle(s).
 - c) **Hold the power tool by insulated gripping surfaces, when performing an operation where the cutting accessory may contact hidden wiring or its own cord.**
Cutting accessory contacting a "live" wire may make exposed metal parts of the power tool "live" and could give the operator an electric shock.
- ##### 2) Safety instructions when using long drill bits
- a) **Never operate at higher speed than the maximum speed rating of the drill bit.** *At higher speeds, the bit is likely to bend if allowed to rotate freely without contacting the workpiece, resulting in personal injury.*
 - b) **Always start drilling at low speed and with the bit tip in contact with the workpiece.** *At higher speeds, the bit is likely to bend if allowed to rotate freely without contacting the workpiece, resulting in personal injury.*
 - c) **Apply pressure only in direct line with the bit and do not apply excessive pressure.** *Bits can bend causing breakage or loss of control, resulting in personal injury.*

INSTALLING THE BELT CLIP

Place provided belt clip in the desired position on the base of the drill. Using a Phillips head #2 screwdriver, place screw through clip into screw hole & hand tighten until you feel resistance & clip is adequately tight.

INSTALLING THE AUXILIARY HANDLE

Align the 2 locating pins of the auxiliary handle mount with the corresponding holes located in the Hammer Drill/Driver aluminium gearbox housing. Rotate the handle clockwise until the auxiliary handle is firmly secured.

Symbols

The rating plate on your tool may show symbols. These represent important information about the product or instructions on its use.

V.d.c.	Voltage direct current, DC		Waste electrical products should not be disposed of with household waste. Please recycle where facilities exist. Check with your Local Authority or retailer for recycling advice.
	Refer to instruction manual/booklet		
	Wear ear protection		General warning
	Wear eye protection		Regulator compliance mark
No.	No Load Speed	min ⁻¹	Revolutions per minute
BPM	Beats per minute		

Know Your Product

K23010

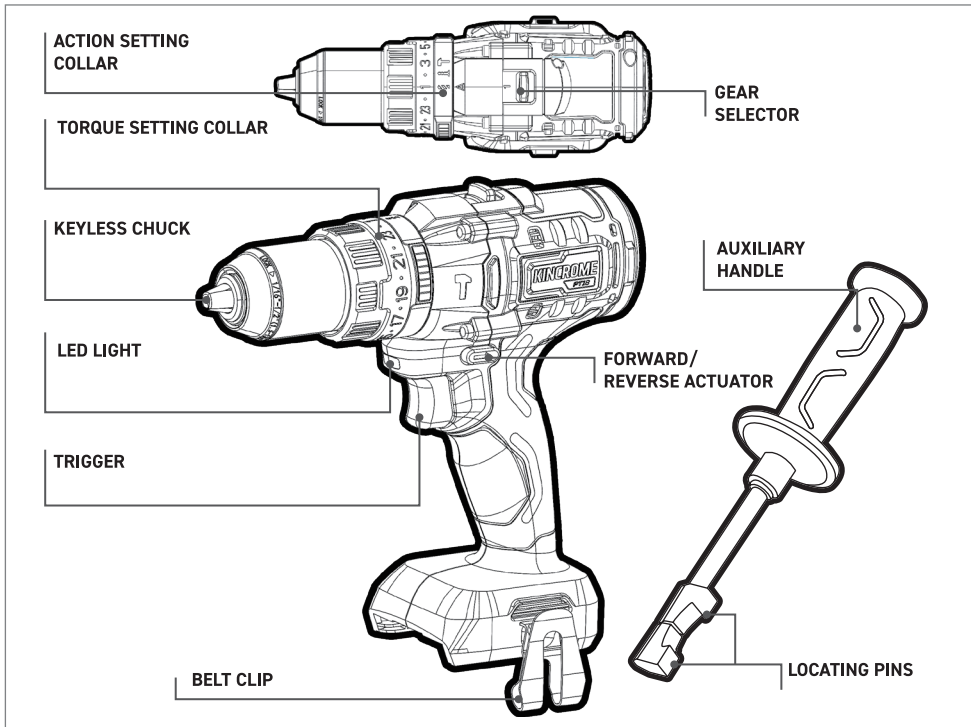

Specifications

Voltage	18Vd.c.	Masonry Drilling capacities	16mm
Keyless chuck size	13mm	No load speed 1	0 - 500 min ⁻¹
Torque settings	23	No load speed 2	0 - 1,750 min ⁻¹
Mode selection	Drill, Hammer, Screwing	Impact rate 1	0 - 8500 BPM
Maximum torque	100Nm	Impact rate 2	0 - 29750 BPM
Wood Drilling capacities	32mm	Weight (no battery)	1.68kg
Steel Drilling capacities	13mm	Noise	80dB

How To Insert Battery On Tool

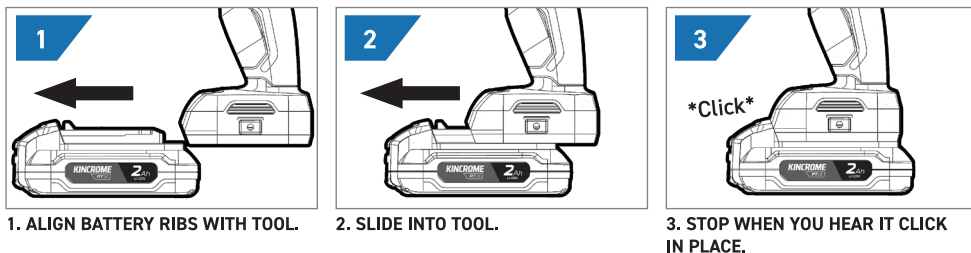

Hammer/Drill Driver Basics

K23010

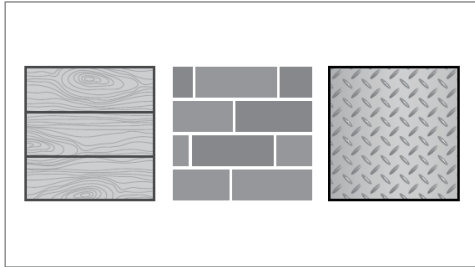

USE ON WOOD, MASONRY OR STEEL

The drill is designed for use on Wood (up to 32mm diameter), Steel (up to 13mm diameter) or Masonry (up to 16mm diameter).
 Note: When drilling steel, use a fine oil or metal cutting compound to reduce risk of the drill bit overheating.

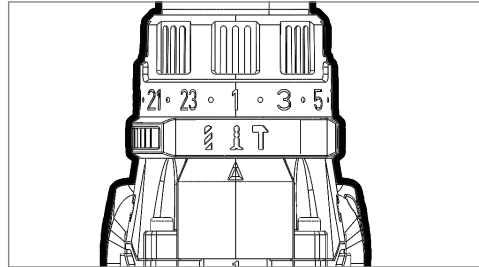

HOW TO ADJUST TORQUE COLLAR

The torque setting can only be used when the screw mode is selected on the action setting collar.
 Hold the collar and rotate to the number desired. The higher the number, the more torque the drill will output.
 Only adjust the collar when the drill is at a complete stop.

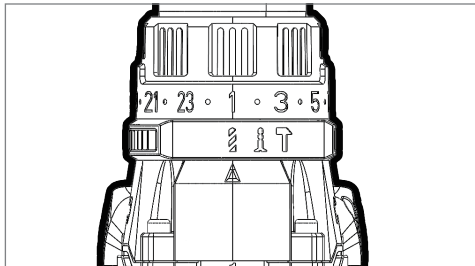

ACTION SETTING COLLAR - DRILL MODE

The drill mode allows for maximum output. This is useful for drilling holes and driving screws when a higher torque is needed. Only adjust the mode when drill is at a complete stop. Rotate the action setting collar to align the arrow on the housing with the drill icon.

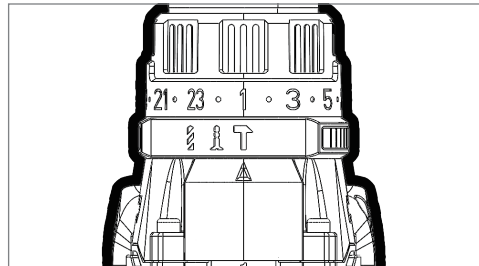

ACTION SETTING COLLAR - HAMMER MODE

The hammer mode allows for drilling of concrete, brick or other masonry, rotate the action setting collar to align the arrow on the housing with the hammer icon.
 Note: 2nd speed is recommended for hammer drilling.

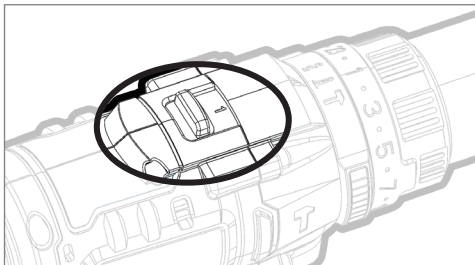

GEAR SELECTOR - GEAR 1 USAGE

The first gear is low speed, high torque.
 Only adjust the gear when drill is at a complete stop.

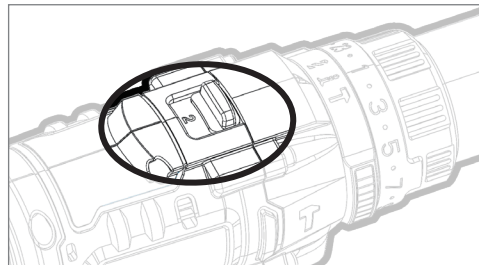

GEAR SELECTOR - GEAR 2 USAGE

The second gear is high speed, low torque.
 Only adjust the gear when drill is at a complete stop.
 If more torque is required use gear 1.

How to insert a Drill Bit

K23010



WARNING: Ensure the tool is switched off and the battery removed before performing any of the following task.

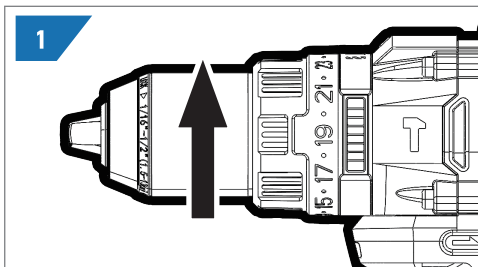

1. LOOSEN THE CHUCK

Holding the drill, place your hand on the keyless chuck and rotate in a clockwise direction. You will notice the jaws of the chuck opening. Once they are wide enough to insert drill bit, stop rotating.

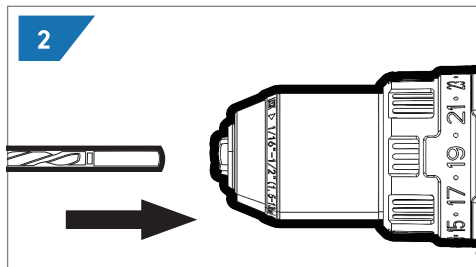

2. SET THE BIT

Make sure the smooth end of the drill bit (the shank) is facing the drill. This is the part that the chuck jaws will hold. Insert the drill bit until it hits the end of the chuck, and pull it back around 1cm.

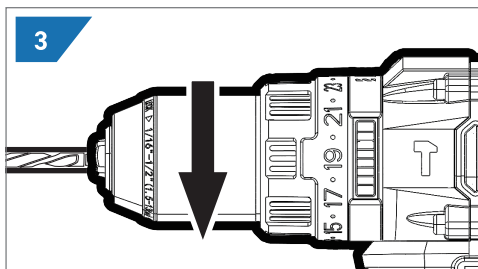

3. TIGHTEN THE CHUCK

Holding the bit, place your hand on the keyless chuck and rotate in an anti-clockwise direction. You will notice the jaws of the chuck closing on the drill bit. Continue to tighten the chuck as tight as possible, ensuring the bit is firmly secured and centered.

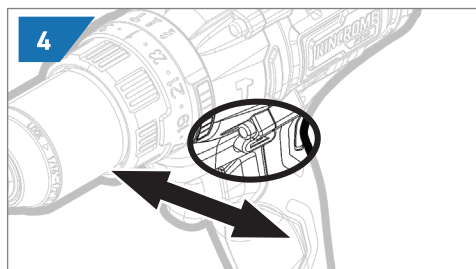

4. SET DRILL DIRECTION FOR USE

Set the forward/reverse actuator to the desired direction:
 Push in from the left - Undoing and removing.
 Push in from the right - Drilling and installing.

Troubleshooting

1. LED LIGHT DOES NOT ILLUMINATE

- a) Check the battery level indicator to ensure the battery is properly charged.
- b) Check the battery is firmly connected to the hammer drill/driver.

2. THE TRIGGER IS LOCKED

Make sure that the forward/reverse button is in the correct position: push it from the left to undo and remove, or push it from the right for drilling and installation. If the button is between these two settings, the trigger will be locked.

If the drill is causing the screw head to strip, ensure that you start with a low torque setting and firmly hold the drill onto the screw head. Increase the torque setting as needed.

If the drill cuts out during use, it is possible that the battery charge is completely depleted. Place the battery on the charging cradle for 3-5 hours.

In case you notice sparking visible through the housing air vents, it is normal to see a small amount of sparking. This does not indicate any problem or malfunction.

How to use the Drill

K23010

1. ENSURE SAFETY

Always wear safety glasses when working with the drill. Do not wear loose clothing or jewellery. Keep your hair, clothing and gloves away from moving parts. In appropriate situations make sure you wear ear muffs, a mask or a respiratory mask.

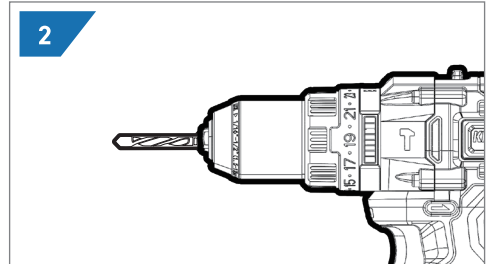

2. MAKE SURE YOU HAVE THE RIGHT BIT

Always read the packaging & instructions for correct usage included with the drill bit to ensure it is appropriate for the task.

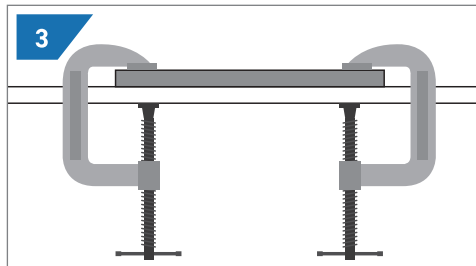

3. SECURE WORKPIECE

Make sure your workpiece is securely fastened to the surface to ensure no movement when drilling.

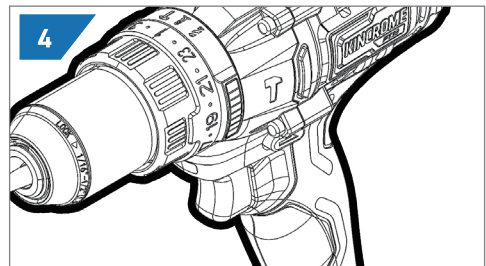

4. ENSURE DRILL IS SET UP CORRECTLY

Make sure you are in the correct gear, clutch setting & direction for the task you have planned.

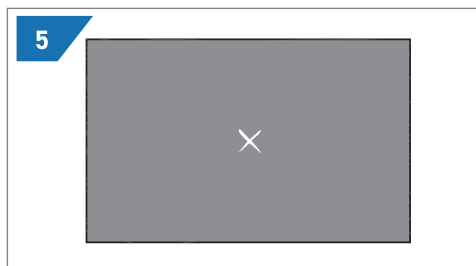

5. MEASURE TWICE, DRILL ONCE

Have your job planned and marked out. When drilling steel or a smooth surface a centre punch should be used to mark out area.

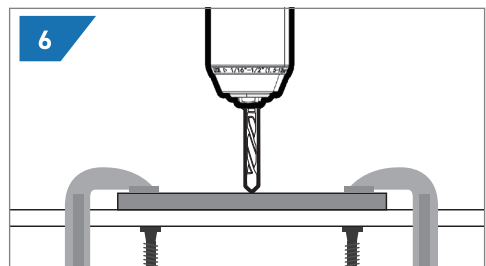

6. DRILL YOUR WORKPIECE

Hold the drill securely and press the trigger whilst applying light pressure into the workpiece. You should not apply excessive force, the drill bit should do the work for you.

Hammer Drill/Driver Features

K23010

The Kincrome Hammer Drill/Driver has an internal battery protection device, this electronic control device ensures a long service life.

1. OVERLOAD PROTECTION

When the hammer drill/driver is overloaded, the motor comes to a stop. Relieve the load on the tool immediately and release the trigger. Restart the tool as normal.

Note: Continuous overloading may cause permanent damage to tool or battery pack.

2. TEMPERATURE OVERLOAD PROTECTION

When the load is too high or the allowable battery temperature is too hot, the electronic control device turn off the tool until the temperature is in the optimum temperature range again.

3. PROTECTION AGAINST DEEP DISCHARGING

The Li-ion battery is protected against over discharging. When the battery is flat, the electronic control device turns off and the tool motor comes to a stop.

Remove and charge immediately to avoid any battery deterioration.

Note: The indicated battery capacity may be lower than the actual charge during use or immediately after use.

4. TORQUE SETTING



Note: The torque setting can only be used on screw mode. The torque is adjusted by rotating the torque setting collar. The torque is greater when the torque adjustment ring is set on a higher setting. The torque is less when the torque adjustment ring is set on a lower setting.

Recommended setting as follows:

1 - 4	Using small screws
5 - 9	Securing screws into soft material
10 - 18	Securing screws into soft and hard material
15 - 22	Securing screws into hard wood
23	Securing larger screws

5. ACTION SETTING

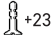
The hammer drill/driver has 3 setting which is controlled by the action setting collar:

	Drilling mode (rotation only)
 +23	Screw driving mode (rotation with clutch)
	Hammer drilling mode (rotation with hammering)

Maintenance

This power tool normally requires no maintenance; from time to time the ventilation slots on the motor casing should be cleaned out. If the unit should become defective, repair should be performed by an authorized service agent for electric tools.

When cleaning plastic parts, it is advisable to refrain from using solvents. Many types of commercial solvents can potentially harm plastics and cause damage. Instead, opt for clean cloths to effectively eliminate dirt, dust, oil, grease and similar substances.

Spare Parts

For a full list of available spare parts for this item visit the Kincrome website www.kincrome.com.au or alternatively contact Kincrome Customer Service.

Office Contact Details



Phone: 1300 657 528

 Email: enquiries@kincrome.com.au

 Website: www.kincrome.com.au

Warranty



3 YEAR STANDARD
+2 FURTHER YEARS WHEN
REGISTERED ONLINE

Our goods and services come with guarantees that cannot be excluded under the Australian Consumer Law. For major failures with the service, you are entitled: -to cancel your service contract with us; and -to a refund for the unused portion, or to compensation for its reduced value. You are also entitled to choose a refund or replacement for major failures with goods. If a failure with the goods or a service does not amount to a major failure, you are entitled to have the failure rectified in a reasonable time. If this is not done you are entitled to a refund for the goods and to cancel the contract for the service and obtain a refund of any unused portion. You are also entitled to be compensated for any other reasonably foreseeable loss or damage from a failure in the goods or service. Kincrome Australia Pty Ltd of 3 Lakeview Drive, Caribbean Park, Scoresby, Victoria (Tel 1300 657 528) also provides the Kincrome Limited Lifetime Guarantee, 5 Year Warranty, 5 Year (3+2) warranty, 3 Year Warranty, 2 Year Warranty and 12-Month Warranty (Kincrome Express Warranties) in respect of some of its products. If a product is covered by a Kincrome Express Warranty and it has materials or workmanship defects (other than defects caused by abnormal or non warranted use) which are covered under the terms of the relevant Kincrome Express Warranty, you can, at your cost, send the product to the above address for repair or replacement. Your rights under a Kincrome Express Warranty are in addition to any other rights you have under the Australian Consumer Law or other applicable laws. For further details and terms please check our product guide, visit www.kincrome.com.au or call us. Every effort is made to ensure advertised stock is available, but due to factors beyond the control of Kincrome Australia Pty. Ltd, not all products advertised in this catalogue may be available at all stores. Kincrome Australia Pty. Ltd. reserves the right to correct printing errors. All sizes shown are approximate only. Accessories shown do not come with the product unless otherwise specified. Due to printing process, colours in this catalogue may vary slightly to actual item. E. & O. E. © Copyright 2022. Reproduction in whole or in part is prohibited without written approval.