

## TRUCK BOX 6 DRAWER K7850/K7850W

### Operation Manual

#### Caution: Take Safety Precautions When Using Your Toolbox



Do not open more than one drawer at a time unless mounted



Do not step on drawers



Do not let children near the Toolbox



Do not exceed Drawer Load Limit (45kgs)



Suitable for mounting to vehicles



Ensure box is secured to vehicle



Lock drawers and lid before moving the toolbox or driving the vehicle



#### IMPORTANT:

THIS OPERATING MANUAL CONTAINS IMPORTANT SAFETY INFORMATION. READ CAREFULLY AND UNDERSTAND ALL INFORMATION BEFORE OPERATING TRUCK BOX. SAVE THIS MANUAL FOR FUTURE USE



### Parts List



2 x Keys

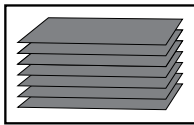

7 x EVA Liners

#### TOOL CHEST SPECIFICATIONS

	Width	Depth	Height
<b>Overall</b>	1000mm	500mm	670mm
<b>Top Area</b> (including lid)	845mm	424mm	118mm
<b>Drawers</b>	685mm	400mm	45mm
<b>Deep Drawer</b>	685mm	400mm	90mm
<b>Weight</b>	93Kg		

#### MAINTENANCE

- Ensure the box locking latches, handles are securely closed and locked at all times
- Regularly maintain and adjust locking mechanism to ensure they close tightly
- Regularly lubricate and clean hinges and front/rear of locking system with light oil
- Regularly lubricate lock barrels with graphite powder or silicone spray
- Regularly inspect rubber weather seal and repair or replace if worn or broken using quality silicon to attach
- Periodically check for leaks and water entry points and use a quality silicone sealant to rectify leaks (Check locks, latches, hinges, seals, welds, mounting points)
- Use quality silicone sealant on all mounting point fasteners and ideally use a rubber mat between the base of the storage item and vehicle to reduce vibration and product fatigue
- Periodically tighten all hardware.
- Lubricate the slides twice a year.
- Use a damp microfibre cloth to clean all surfaces.

**WARNING:** Avoid cleaning with hoses & high pressure cleaners as water ingress can occur.

### Drawer Removal

#### 1 Removing the Drawers

- Fully extend the empty drawer.
- Push down the right release lever while pushing up the left release lever.
- Pull the drawer outward until it is released from the drawer slide.

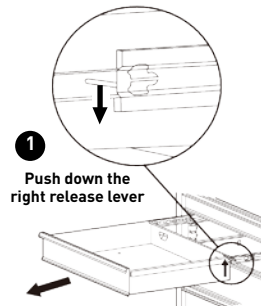
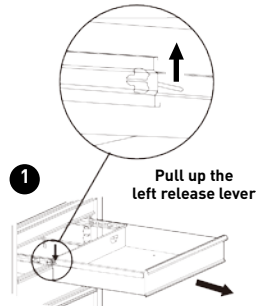

#### 2 Re-Inserting The Drawers

- Extend the drawer slides.
- Insert the brackets on each side of the drawer into the slots on the slides, being careful that they are properly positioned.
- Once properly inserted, completely close the drawer to set the slides in their proper positions.

### TOOLS & ASSISTANCE NEEDED

&

**Mechanical Assistance**

2 People Lift

## TRUCK BOX 6 DRAWER K7850/K7850W

### Mounting & Lifting

#### Permanent

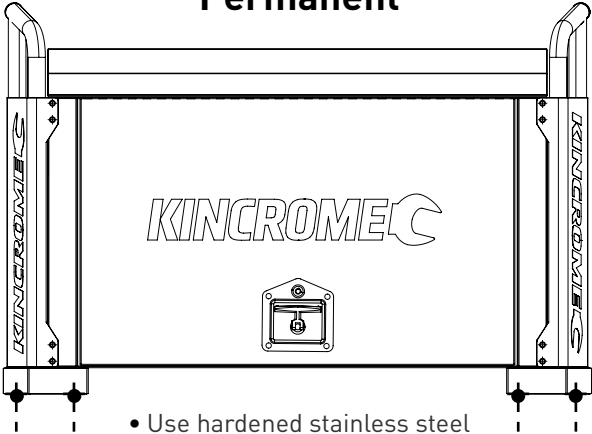

- Use hardened stainless steel bolts & fasteners with appropriate thread locker or locking nuts when mounting to vehicle trays.

#### Temporary

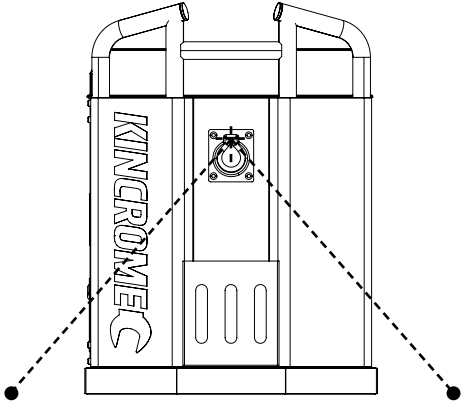

- Use appropriately rated and approved tie downs to secure the box to the vehicle.

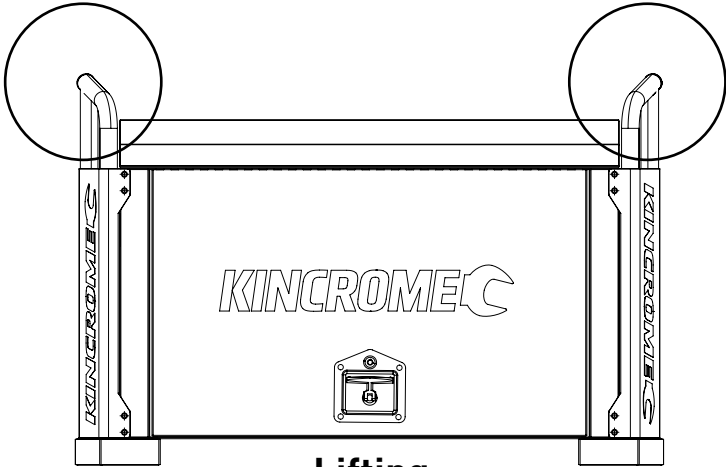

#### Lifting



2 People Lift

Use roll cage carry points to lift.  
**NOTE:** Manual lift only when empty.  
 Mechanical assistance is recommended.

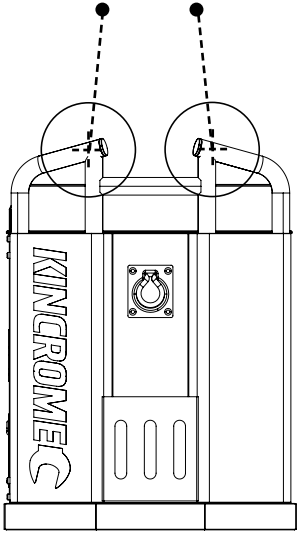

#### Hoisting

- Use appropriately approved and rated hoist straps and crane, hoist or forklift.

### Specifications

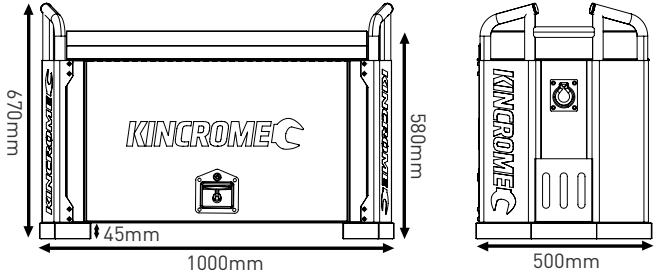

# TRUCK BOX 6 DRAWER K7850/K7850W

## Replacement Parts



### REPLACEMENT PARTS

ITEM	PART NO.	DESCRIPTION	QUANTITY
1	K7850-1	Lock Barrel & Key	1
2	K7850-2	T-Handle Lock & Key	1
3	K7850-3	Gas Struts (x1)	2
4	K7850-4	Roll Cage Bolt Pack (x10)	2

ITEM	PART NO.	DESCRIPTION	QUANTITY
5	K7850-5	Ball Bearing Slides (Pair)	6
6	K7850-6	Tie Down Anchor	2
7	K7850-7	EVA Mat Pack (x7)	1
8	K7850-8	Rubber Lid Seal	1