

**72" Pit Cart**  
Model: K7872

# ATTENTION

1. To reduce the risk of injury, read and follow all safety and assembly instructions before using this product for the first time. Save these instructions for future reference.
2. Fill in the following information and retain for future reference:

Model #: \_\_\_\_\_

Date of purchase: \_\_\_\_\_

Place of purchase: \_\_\_\_\_

Receipt # of purchase: \_\_\_\_\_



DO NOT OPEN MORE THAN  
ONE DRAWER AT A TIME.



DO NOT STEP ON DRAWERS.



DO NOT ALLOW CHILDREN  
NEAR THE UNIT.



DO NOT LIFT UNIT BY YOURSELF.



SET THE BRAKE ON THE HANDLE  
UNLESS YOU ARE MOVING THE UNIT.



LOCK DRAWERS BEFORE  
MOVING THE UNIT.

# PARTS LIST

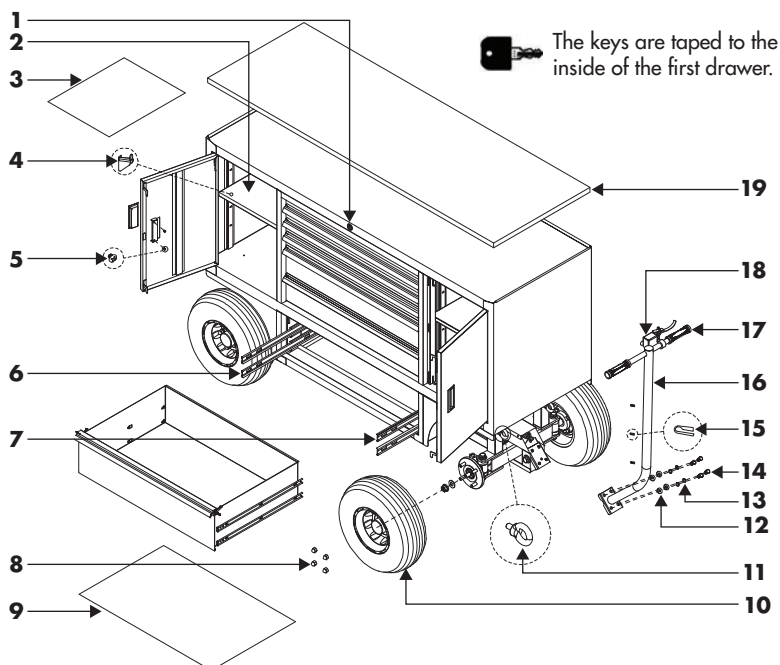

REF #	PART NAME	PART #	QTY
1	Lock	K7872-1	1
2	Shelves	K7872-2	2
3	Shelf Liners	K7872-3	4
4	Shelf Supports	K7872-4	8
5	M4 x 5 mm Phillips Head Bolts	K7872-5	4
6	Slides (L)	K7872-6	10
7	Slides (R)	K7872-7	10
8	Cap Nuts	K7872-8	16
9	Drawer Liners	K7872-9	7
10	Tyres	K7872-10	4
11	Ring Bolts	K7872-11	4
12	Washers	K7872-12	4
13	Spring Washers	K7872-13	4
14	M10 x 30 mm Hex Bolts	K7872-14	4
15	Positioning Rubbers	K7872-15	3
16	Control Handle	K7872-16	1
17	Handle Covers	K7872-17	2
18	Brake Mechanism	K7872-18	1
19	Work Top	K7872-19	1

Replacement parts can be ordered by calling (+61) 1300-657-528. Please have your original receipt, part number and quantity ready when you order.

Replacement keys may be ordered using the code that appears on the face of the lock.

## CONTROL HANDLE ATTACHMENT

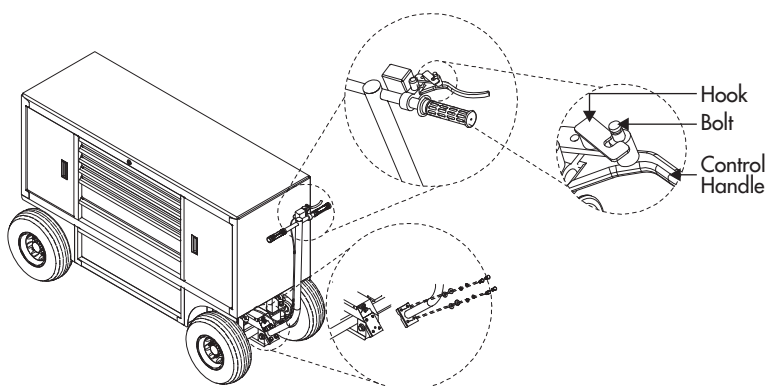

**NOTE:** Remove the bolts prior to attempting control handle attachment.

After removing the pit cart from the package, install the control handle as shown above. Insert the M10 x 30 mm hex bolts through the spring washers and washers, then through the control handle and into the base of the pit cart.

## BRAKE LOCKING AND UNLOCKING

Unlocked

Locked

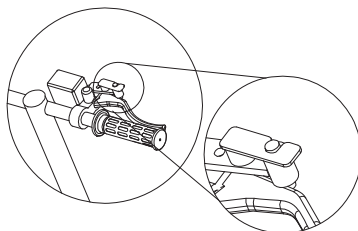
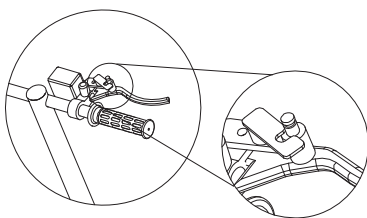

**BRAKE UNLOCK:** To unlock the brake, release the hook from the bolt. The control handle will be released and the pit cart can be moved.

**BRAKE LOCK:** To lock the brake, slide the hook over the bolt. The handle will be prevented from moving and the brake will be locked.

## RAISE & RELEASE DRAWER FRONTS

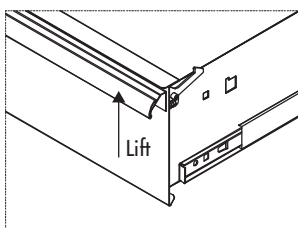

These units are equipped with raise and release drawer fronts. To open, lift up on the drawer front while pulling it towards you. To close, shut the drawer firmly until the latch engages.

If the drawer does not stay closed, the hook may be bent or it may be rubbing against the drawer slides. Lightly bend the hook until the drawer will engage in the slide.

## DRAWER REMOVAL AND REPLACEMENT

Push down  
(left hand side)

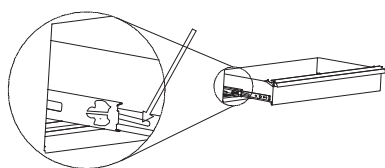

Pull up  
(Right hand side)

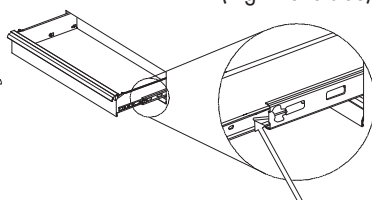

To remove a drawer, pull it out so it's almost fully extended. Pull up on the right hand black release lever, while pushing down on the left hand black release lever. While holding the levers in these positions, pull the drawer outward until it is released from the drawer slide.

To replace a drawer, extend the drawer slides from the tool chest or cabinet. Insert the brackets on each side of the drawer into the slots in the slides, making sure that they are properly inserted. Completely close the drawer to set the slides in their proper positions.

DO NOT stand on this product. You may fall, which may cause personal injury.

WEAR SAFETY GLASSES when removing or repositioning the slides. The tool could slip, which may cause personal injury.

When moving this product, do not pull it. Push the product to prevent personal injury.

USE THE BRAKES when not moving this product. This will prevent the product from rolling, which may cause personal injury or product damage.

BE CAREFUL when opening more than one drawer. The product may become unstable and tip, which may cause personal injury or product damage.

DO NOT mount this product on a truck bed or any other moving object. This may cause personal injury or product damage.

Secure this product properly before moving it with a forklift.

DO NOT tow with power equipment. The product could tip, which may cause personal injury or product damage.

DO NOT alter this product in any manner. For example, do not weld external lockbars or attach electrical equipment. This may cause product damage or personal injury.

Keep the product on level surfaces. The product may become unstable and tip if stored or moved on an un-level surface, which may cause personal injury or product damage.

Lock the drawers before moving this product. The drawers could come open and make the product unstable and tip, which may cause personal injury or product damage.

## GENERAL MAINTENANCE

Lubricate the slides (twice a year).

Periodically clean the drawer fronts, drawer trim and other surfaces with mild detergent and water.

Grease and oil can be removed with most standard cleaning fluids. For safety, use a nonflammable cleaning fluid.

Periodically check the tyre pressure level.

The wheels can be cleaned with soap and water.

## FLAT REPAIR

If air leaks from a wheel over a long time, re-inflate the tyre.

If a wheel is pierced by a nail or other sharp object, repair the tyre as you would a car tyre or change the tyre.

**KINCROME**  
TOOLS + EQUIPMENT™

---

### National Head Office

National Distribution and Showroom  
3 Lakeview Dve, Caribbean Business Park  
Scoresby Victoria 3179 Australia

### Administration

T (03) 9730 7100  
F (03) 9730 7199

### Customer Service Centre

T 1300 657 528  
F 1300 556 005

E [enquiries@kincrome.com.au](mailto:enquiries@kincrome.com.au)  
W [kincrome.com.au](http://kincrome.com.au)